

STANDARD ENGINEERING NOTES

1. THESE PLANS ARE SUBJECT TO THE INTERPRETATION OF INTENT BY THE ENGINEER. ALL QUESTIONS REGARDING THESE PLANS SHALL BE PRESENTED TO THE ENGINEER. ANYONE WHO TAKES IT UPON THEMSELVES THE INTERPRETATION OF THE DRAWINGS OR MAKES REVISIONS TO THE SAME WITHOUT CONFERRING WITH THE DESIGN ENGINEER SHALL BE RESPONSIBLE FOR THE CONSEQUENCES THEREOF.
2. PRIOR TO BIDDING THE WORK, THE CONTRACTOR SHALL THOROUGHLY SATISFY HIMSELF AS TO THE ACTUAL CONDITIONS, REQUIREMENTS OF THE WORK AND EXCESS OR DEFICIENCY IN QUANTITIES. NO CLAIMS SHALL BE MADE AGAINST THE OWNER/DEVELOPER OR ENGINEER FOR ANY EXCESS OR DEFICIENCY THEREIN, ACTUAL OR RELATIVE.
3. THE ENGINEER SHALL NOT BE RESPONSIBLE FOR CONSTRUCTION MEANS, METHODS, TECHNIQUES, SEQUENCES, PROCEDURES OR SAFETY PRECAUTIONS OR PROGRAMS UTILIZED IN CONNECTION WITH THE WORK, AND WILL NOT BE RESPONSIBLE FOR THE CONTRACTOR'S FAILURE TO CARRY OUT THE WORK IN ACCORDANCE WITH THE CONTRACT DOCUMENTS.
4. THE ENGINEER SHALL NOT BE RESPONSIBLE FOR COORDINATING THE RELOCATION OF UTILITIES, LIGHTS, IRRIGATION ETC.
5. THE CONTRACTOR IS TO VERIFY THE LOCATION, ELEVATION, CONDITION, AND PAVEMENT CROSS-SLOPE OF ALL EXISTING SURFACES AT POINTS OF TIE-IN AND MATCHING, PRIOR TO COMMENCEMENT OF CONSTRUCTION. SHOULD EXISTING LOCATIONS, ELEVATIONS, CONDITION, OR PAVEMENT CONFLICT WITH ADA OR FIH PLAYING FIELD REQUIREMENTS, THE CONTRACTOR SHALL NOTIFY THE OWNER'S AGENT IMMEDIATELY FOR DIRECTION ON HOW TO PROCEED PRIOR TO COMMENCEMENT OF CONSTRUCTION. THE CONTRACTOR ACCEPTS RESPONSIBILITY FOR ALL COSTS ASSOCIATED WITH CORRECTIVE ACTION IF THESE PROCEDURES ARE NOT FOLLOWED.
6. EXISTING UTILITIES ARE NOT SHOWN. CALL UNDERGROUND SERVICE ALERT PRIOR TO CONSTRUCTION. THE COLLEGE CAN BE COORDINATED WITH TO MARK KNOWN UTILITIES BELONGING TO THE COLLEGE. THE CONTRACTOR SHALL PROTECT AND MAINTAIN ALL EXISTING UTILITIES ON THE SITE. ANY DAMAGE TO EXISTING UTILITIES, WHETHER SHOWN OR NOT ON THE DRAWING, SHALL BE REPAIRED/REPLACED AT THE CONTRACTOR'S EXPENSE. EXISTING SURFACE FEATURES AND FENCING SHALL BE REPLACED IN KIND.
7. THE ENGINEER AND APPLICABLE AGENCY MUST APPROVE, PRIOR TO CONSTRUCTION, ANY ALTERATION, OR VARIANCE FROM THESE PLANS. ANY VARIATIONS FROM THESE PLANS SHALL BE PROPOSED ON CONSTRUCTION FIELD PRINTS AND TRANSMITTED TO THE ENGINEER.
8. ANY INSPECTION BY ANY JURISDICTIONAL AGENCY, SHALL NOT, IN ANY WAY, RELIEVE THE CONTRACTOR FROM ANY OBLIGATION TO PERFORM THE WORK IN STRICT COMPLIANCE WITH APPLICABLE CODES AND AGENCY REQUIREMENTS.
9. ANY HAULING PERMITS REQUIRED ARE TO BE OBTAINED BY THE CONTRACTOR AT NO ADDITIONAL COST TO THE OWNER.
10. ANY CONSTRUCTION WATER ACCESS IS TO BE OBTAINED BY THE CONTRACTOR AT NO ADDITION COST TO THE OWNER. FIRE HYDRANT ACCESS MUST BE PERMITTED AND METERED BY THE COUNTY WATER DISTRICT 1 AT NO ADDITIONAL COST TO THE OWNER.
11. CONTRACTOR IS RESPONSIBLE FOR PROTECTING ALL STORM DRAIN PIPES AND DRAINAGE FACILITIES FROM DAMAGE DURING ALL STAGES OF CONSTRUCTION.

PARTIAL LIST OF APPLICABLE CODES AS OF JANUARY 1, 2017

- 2016 CALIFORNIA ADMINISTRATIVE CODE, PART 1, TITLE 24 C.C.R.
- 2016 CALIFORNIA BUILDING CODE (CBC), PART 2, TITLE 24 C.C.R.
- 2016 CALIFORNIA ELECTRICAL CODE (CEC), PART 3, TITLE 24 C.C.R.
- 2016 CALIFORNIA FIRE CODE, PART 9, TITLE 24 C.C.R.
- 2016 CALIFORNIA GREEN BUILDING STANDARDS CODE, PART 11, TITLE 24 C.C.R.
- 2016 CALIFORNIA REFERENCE STANDARDS, PART 12, TITLE 24 C.C.R.
- TITLE 19 C.C.R., PUBLIC SAFETY, STATE FIRE MARSHALL REGULATIONS

NOTES:

1. SOME CODES MAY NOT APPLY IF WORK REGULATED BY SUCH CODE IS NOT WITHIN THE SCOPE OF THIS PROJECT.



Section 4216/4217 of the government code requires a dig alert identification number be issued before a "permit to excavate" will be valid.

Call (2) working days before you dig.

COLLEGE OF THE SISKIYOU'S SYNTHETIC TURF SOCCER FIELD

800 COLLEGE AVE, WEED, CA 96094

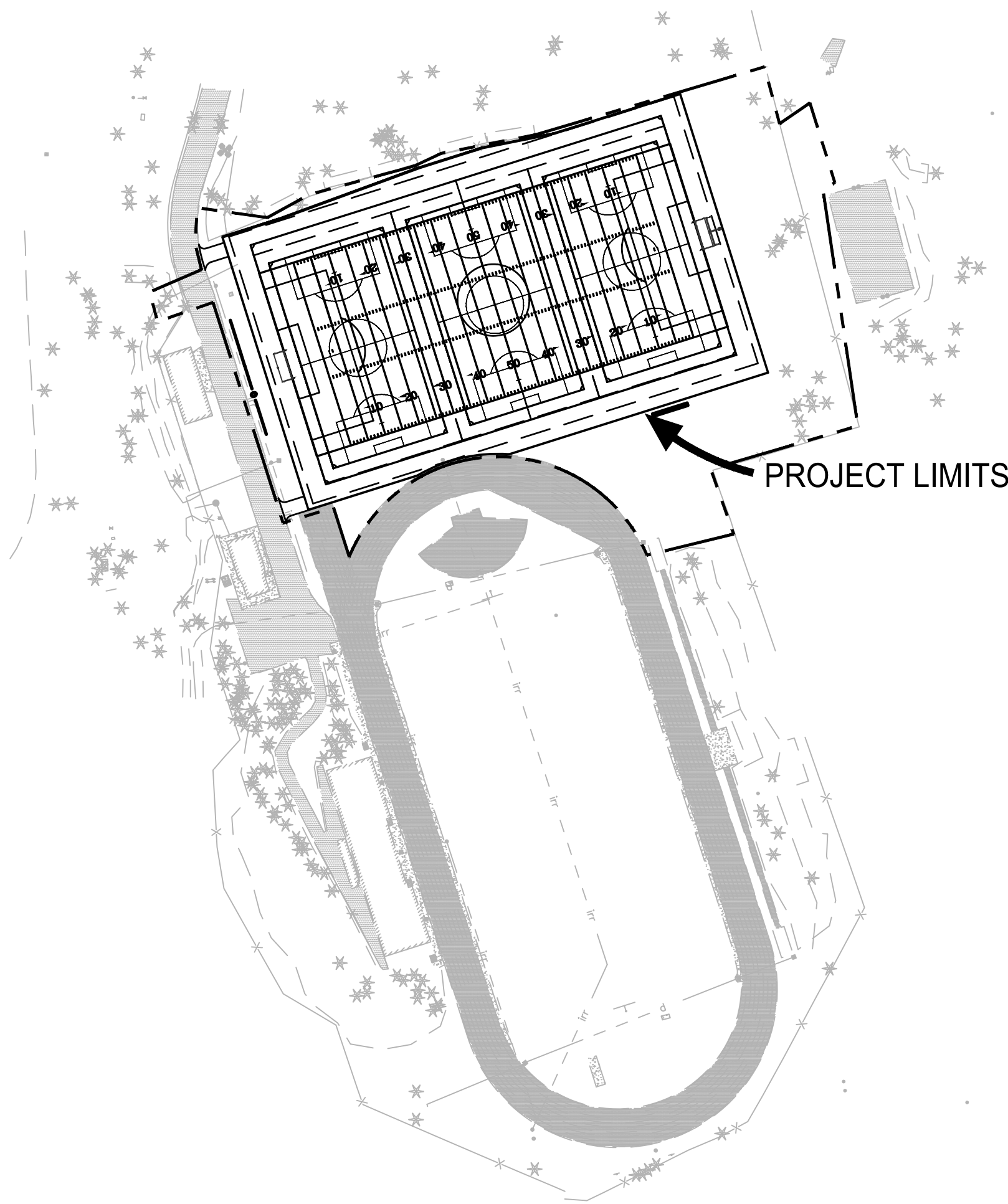

LOCATION MAP
SCALE 1"=200'

SCOPE OF WORK

THE PROJECT SCOPE OF WORK INCLUDES REMOVAL OF EXISTING GRASS FIELD AND INSTALLATION OF SYNTHETIC TURF SOCCER FIELD.

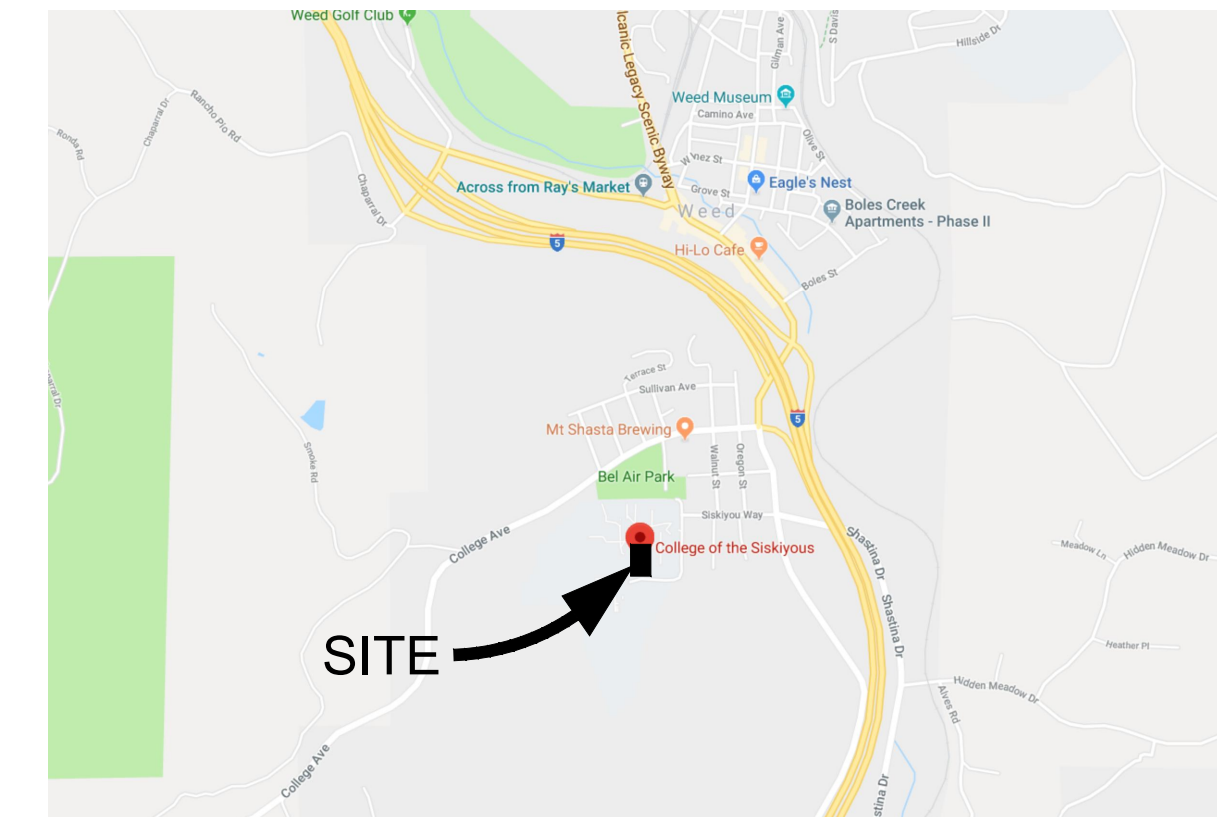

VICINITY MAP
N.T.S.

SHEET INDEX

- PF-01 COVER SHEET
- PF-02 DEMOLITION PLAN
- PF-03 SURFACING PLAN
- PF-04 GRADING PLAN
- PF-05 DRAINAGE PLAN
- PF-06 IRRIGATION PLAN
- PF-07 PLANTING PLAN
- PF-08 DIMENSION PLAN
- PF-09 GRAPHICS PLAN
- PF-10.1 DETAILS

OWNER

COLLEGE OF THE SISKIYOU'S
800 COLLEGE AVE,
WEED, CA 96094
PH: (530) 938-5555

ENGINEER

ANTHONY STEVENSON
LLOYD CIVIL & SPORTS ENGINEERING LLC.
7349 N. VIA PASEO DEL SUR
SUITE 515-324
SCOTTSDALE, AZ 85258
(602) 635-4226
EMAIL: astevenson@lloydengineers.com

LANDSCAPE ARCHITECT

BRETT LONG
LLOYD CIVIL & SPORTS ENGINEERING, LLC
7349 N. VIA PASEO DEL SUR
SUITE 515-324
SCOTTSDALE, AZ 85258
(408) 338-6048
EMAIL: blong@lloydengineers.com

**PRELIMINARY NOT
FOR CONSTRUCTION**

REV.	

**COLLEGE OF THE SISKIYOU'S
SOCCER FIELD**
800 College Avenue
Weed, CA

SCALE:	AS NOTED
DESIGNED:	BTL
DATE:	8/30/2018
DRAWN:	TML
PROJ.	17-173
APPROVED:	

COVER

DWG. NO.

PF-01

GENERAL NOTES:

1. CONTRACTOR MUST REMOVE AND DISPOSE OF ALL WEEDS, LOOSE MATERIALS, AND THOROUGHLY CLEAN THE TRACK/RUNWAY AREAS TO RECEIVE THE NEW SYNTHETIC SURFACE.
2. AT THE CONCLUSION OF THE REPAIRS AND PREPARATION NO EXPOSED CONCRETE SURFACES SHALL BE VISIBLE ALONG THE PERIMETER AND OR EDGES OF ANY AREAS INTENDED FOR A SYNTHETIC TRACK AND FIELD RUNNING OR JUMPING SURFACE.
3. EXISTING STORM DRAIN FACILITIES WITHIN THE LIMITS OF CONSTRUCTION MUST BE PROTECTED FROM CONSTRUCTION DEBRIS INTRUSION AND MUST BE FLUSHED OUT AND CLEANED BY THE CONTRACTOR AT THE END OF CONSTRUCTION.
4. THE CONTRACTOR SHALL PROVIDE AND INSTALL EROSION CONTROL ITEMS SUCH AS SILT FENCING, HAY BALES, STABILIZED CONSTRUCTION ENTRANCES, AND INLET SEDIMENT TRAPS AS REQUIRED BY LOCAL CODE. THE CONTRACTOR IS RESPONSIBLE TO PROVIDE ANY EROSION CONTROL PLANS REQUIRED BY GOVERNMENT AGENCIES, AND OBTAIN ANY REQUIRED PERMITS.
5. CONTRACTOR IS RESPONSIBLE FOR MAINTAINING IRRIGATION SERVICE TO EXISTING LANDSCAPE MATERIAL TO REMAIN AND TO ADJACENT FIELDS BOTH DURING AND AFTER CONSTRUCTION.
6. THE CONTRACTOR MUST CONTACT LOCAL UTILITY LOCATION SERVICES PRIOR TO CONSTRUCTION.
7. THE CONTRACTOR MUST PROTECT IN PLACE ALL EXISTING UTILITIES. THE CONTRACTOR IS RESPONSIBLE FOR REPAIR OR REPLACEMENT OF UTILITIES DAMAGED DURING CONSTRUCTION.
8. THE CONTRACTOR MUST PROTECT IN PLACE IMPERMEABLE LINER. THE CONTRACTOR IS RESPONSIBLE FOR REPAIR OR REPLACEMENT WHERE DAMAGED.
9. THE QUANTITY AND LOCATION OF INFELD COMBOXES AND IRRIGATION BOXES IS APPROXIMATE. ADDITIONAL BOXES MAYBE LOCATED DURING CONSTRUCTION. THE CONTRACTOR IS RESPONSIBLE FOR RENOVATING ALL INFELD BOXES PER PLAN NOTES AND DETAILS.

TOTAL DISTURBED AREA
 TOTAL DISTURBED AREA = 156,185 SF

LEGEND

	LIMITS OF CONSTRUCTION
	CONTROL POINT
	CATCH BASIN
	IRRIGATION VALVE
	FIRE HYDRANT
	TREE
	WATER VALVE
	POWER METER
	FENCE
	STORM DRAIN LINE
	IRRIGATION LINE
	CONTOUR
	CONCRETE
	ASPHALT
	TRACK SURFACE

PROTECT IN PLACE NOTES

- | | |
|--|---|
| | PROTECT IN PLACE EXISTING ASPHALT ACCESS ROAD. |
| | PROTECT IN PLACE EXISTING TRACK AND FIELD AND ALL ASSOCIATED EQUIPMENT, SPECTATOR AREAS, DRAINAGE INLETS, COMMUNICATION AND IRRIGATION VALVE BOXES. |
| | PROTECT IN PLACE EXISTING TREES. |
| | PROTECT IN PLACE EXISTING LONG JUMP PIT AND RUNWAY. |
| | PROTECT IN PLACE EXISTING ELECTRICAL BOXES, CONDUIT AND LEADS. |
| | PROTECT IN PLACE EXISTING IRRIGATION BOXES. |
| | PROTECT IN PLACE EXISTING STORM DRAIN INLET AND PIPE. |
| | PROTECT IN PLACE EXISTING SITE FENCE. |
| | PROTECT, SALVAGE AND RELOCATE MONUMENT ROCK. |

DEMOLITION NOTES

- | | |
|--|---|
| | REMOVE AND DISPOSE OF EXISTING NATURAL GRASS AND ORGANIC DEBRIS WITHIN LIMITS OF NEW SOCCER FIELD. |
| | REMOVE AND DISPOSE OF EXISTING IRRIGATION LINES AND VALVES WITHIN LIMITS OF NEW SOCCER FIELD. |
| | REMOVE AND DISPOSE OF EXISTING TRACK RUNOUT SURFACING, ASPHALT AND ROCK BASE. DISPOSE OF MATERIALS ACCORDING TO LOCAL CODES AND REQUIREMENTS. |
| | REMOVE AND DISPOSE OF EXISTING STORM DRAIN PIPES AND CATCH BASINS. |
| | REMOVE AND DISPOSE OF EXISTING TREES WITHIN LIMITS OF NEW SOCCER FIELD. |
| | REMOVE AND RELOCATE EXISTING STORAGE CONTAINERS AND ALL RELATED ITEMS IN STORAGE PER OWNERS DIRECTION. |
| | REMOVE AND DISPOSE OF EXISTING FENCE. |
| | REMOVE AND DISPOSE OF EXISTING THROWING CIRCLE CONCRETE. |

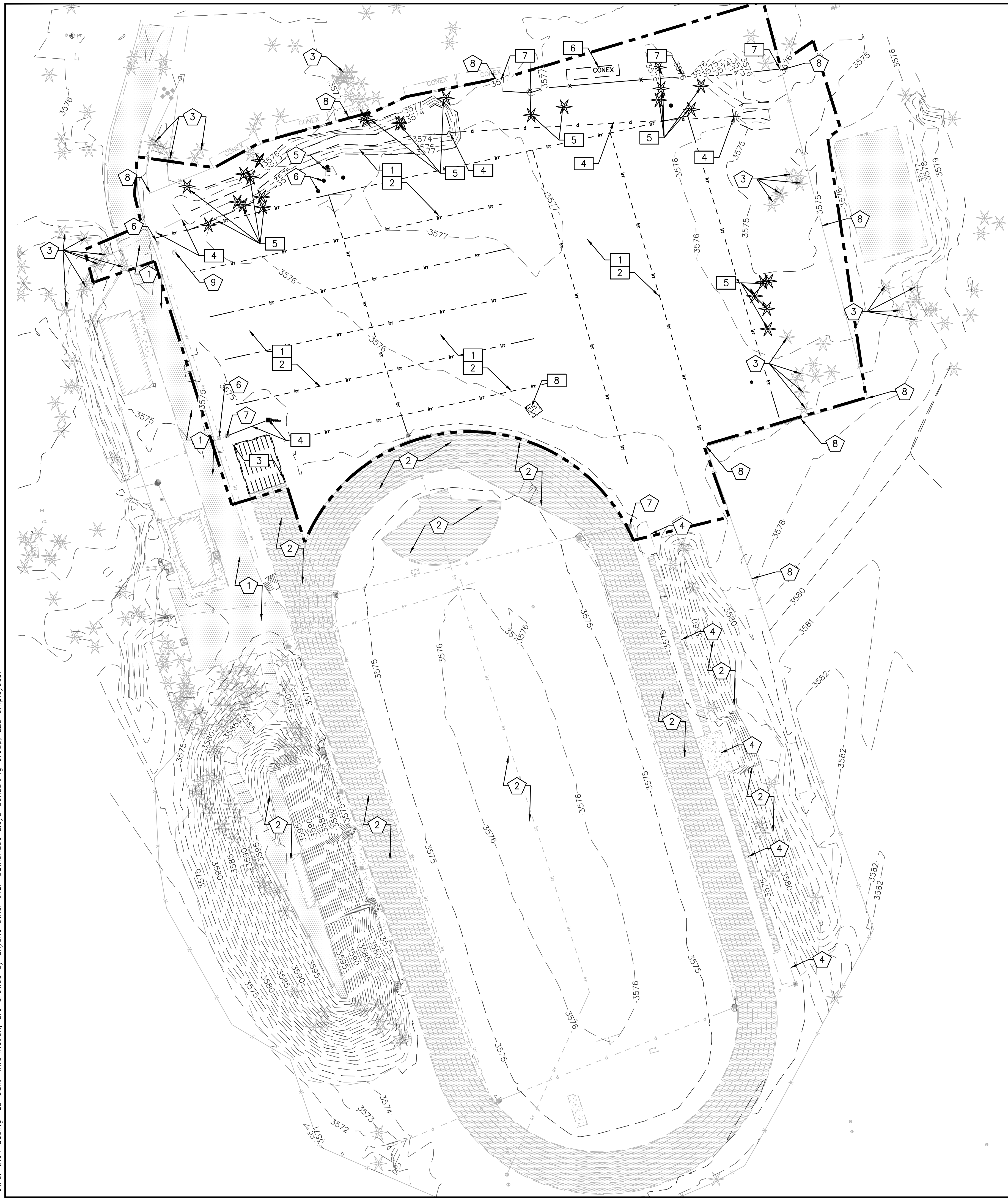

PRELIMINARY NOT FOR CONSTRUCTION

REV.

COLLEGE OF THE SISKIYOU'S SOCCER FIELD
 800 College Avenue
 Weed, CA

SCALE:	1"=40'
DESIGNED:	BTL
DATE:	8/30/2018
DRAWN:	ZTP
PROJ.:	17-173
APPROVED:	

DEMOLITION PLAN

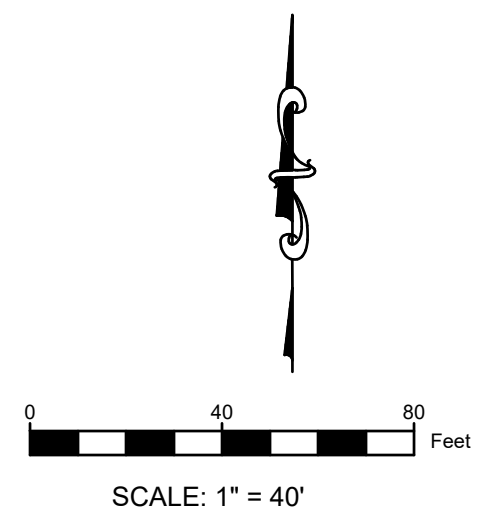

DWG. NO.
PF-02

This plan document set is the sole property of Lloyd Consulting Group, LLC. No alterations to these plans, other than adding "as-built" information, are allowed by anyone other than authorized Lloyd Consulting Group, LLC employees.

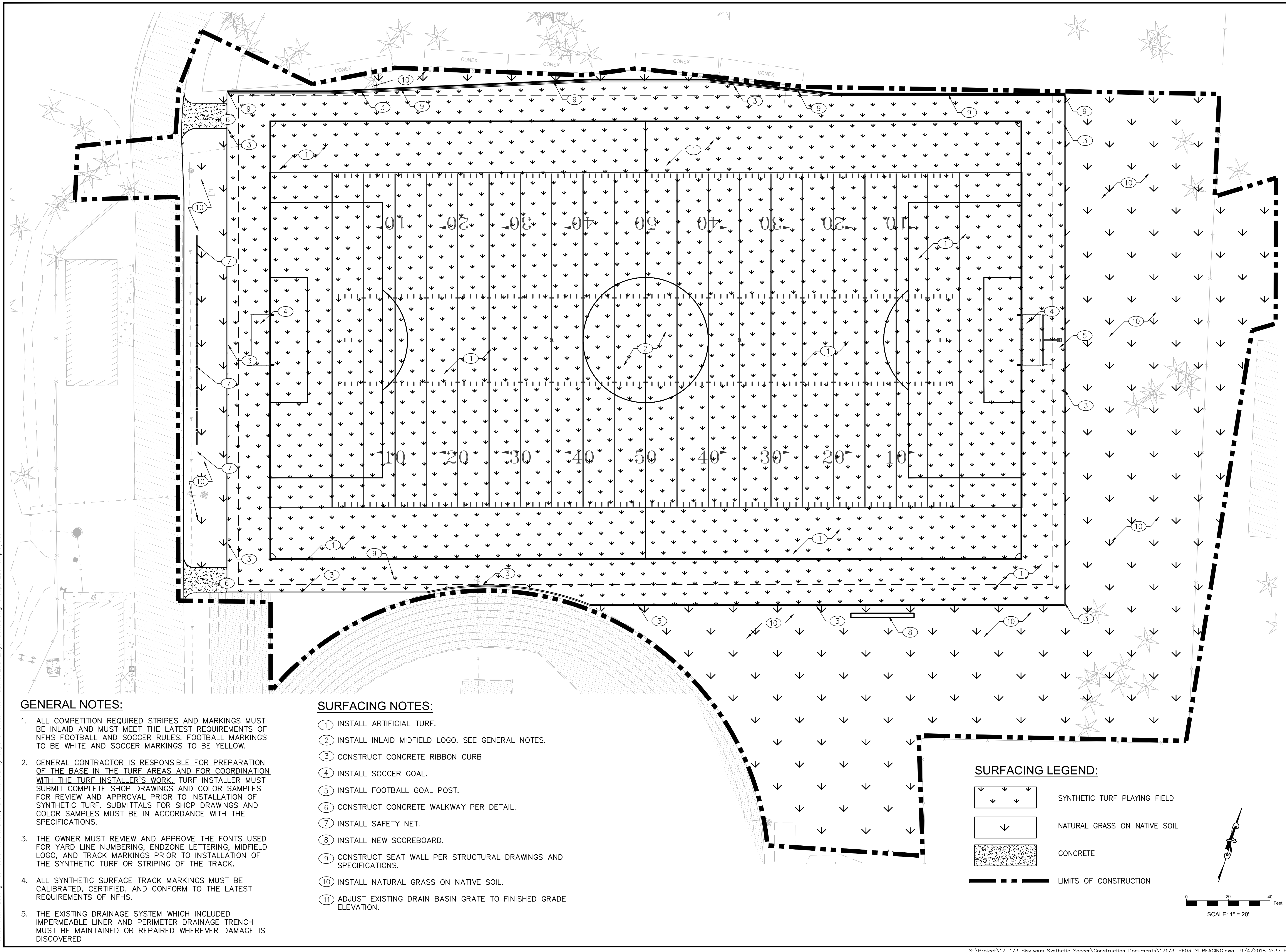

GENERAL NOTES:

1. ALL COMPETITION REQUIRED STRIPES AND MARKINGS MUST BE INLAID AND MUST MEET THE LATEST REQUIREMENTS OF NFHS FOOTBALL AND SOCCER RULES. FOOTBALL MARKINGS TO BE WHITE AND SOCCER MARKINGS TO BE YELLOW.
2. GENERAL CONTRACTOR IS RESPONSIBLE FOR PREPARATION OF THE BASE IN THE TURF AREAS AND FOR COORDINATION WITH THE TURF INSTALLER'S WORK. TURF INSTALLER MUST SUBMIT COMPLETE SHOP DRAWINGS AND COLOR SAMPLES FOR REVIEW AND APPROVAL PRIOR TO INSTALLATION OF SYNTHETIC TURF. SUBMITTALS FOR SHOP DRAWINGS AND COLOR SAMPLES MUST BE IN ACCORDANCE WITH THE SPECIFICATIONS.
3. THE OWNER MUST REVIEW AND APPROVE THE FONTS USED FOR YARD LINE NUMBERING, ENDZONE LETTERING, MIDFIELD LOGO, AND TRACK MARKINGS PRIOR TO INSTALLATION OF THE SYNTHETIC TURF OR STRIPING OF THE TRACK.
4. ALL SYNTHETIC SURFACE TRACK MARKINGS MUST BE CALIBRATED, CERTIFIED, AND CONFORM TO THE LATEST REQUIREMENTS OF NFHS.
5. THE EXISTING DRAINAGE SYSTEM WHICH INCLUDED IMPERMEABLE LINER AND PERIMETER DRAINAGE TRENCH MUST BE MAINTAINED OR REPAIRED WHEREVER DAMAGE IS DISCOVERED

SURFACING NOTES:

- 1 INSTALL ARTIFICIAL TURF.
- 2 INSTALL INLAID MIDFIELD LOGO. SEE GENERAL NOTES.
- 3 CONSTRUCT CONCRETE RIBBON CURB
- 4 INSTALL SOCCER GOAL.
- 5 INSTALL FOOTBALL GOAL POST.
- 6 CONSTRUCT CONCRETE WALKWAY PER DETAIL.
- 7 INSTALL SAFETY NET.
- 8 INSTALL NEW SCOREBOARD.
- 9 CONSTRUCT SEAT WALL PER STRUCTURAL DRAWINGS AND SPECIFICATIONS.
- 10 INSTALL NATURAL GRASS ON NATIVE SOIL.
- 11 ADJUST EXISTING DRAIN BASIN GRATE TO FINISHED GRADE ELEVATION.

SURFACING LEGEND:

- SYNTHETIC TURF PLAYING FIELD
- NATURAL GRASS ON NATIVE SOIL
- CONCRETE
- LIMITS OF CONSTRUCTION

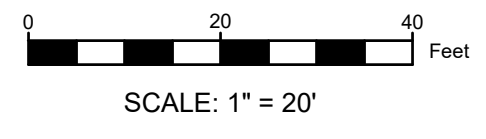

PRELIMINARY NOT FOR CONSTRUCTION

REV.	DESCRIPTION

COLLEGE OF THE SISKIYOU
SOCCER FIELD
 800 College Avenue
 Weed, CA

SCALE:	1"=30'
DESIGNED:	BTL
DATE:	8/30/2018
DRAWN:	ZTP
PROJ.	17-173
APPROVED:	

SURFACING PLAN

DWG. NO.
PF-03

This plan document set is the sole property of Lloyd Consulting Group, LLC. No alterations to these plans, other than adding "as-built" information, are allowed by anyone other than authorized Lloyd Consulting Group, LLC employees.

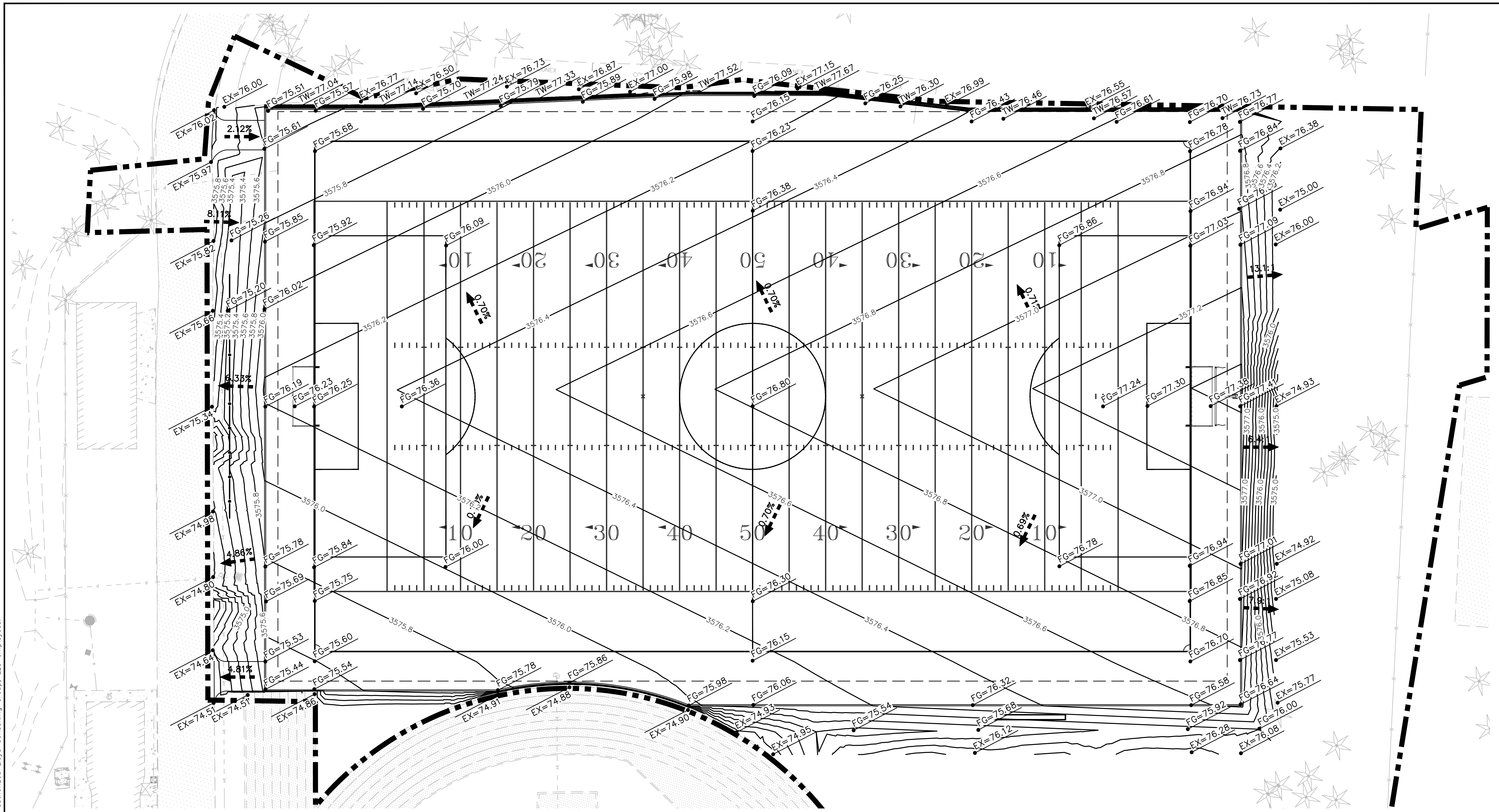

This plan document set is the sole property of Lloyd Consulting Group, LLC. No alterations to these plans, other than adding "as-built" information, are allowed by anyone other than authorized Lloyd Consulting Group, LLC employees.

GRADING NOTES:

- ELEVATIONS SHOWN ARE FINISHED GRADE, TOP OF NATURAL GRASS, CONCRETE PAVEMENT OR TOP OF SYNTHETIC TURF INFILL.
- CONTRACTOR MUST PROVIDE SMOOTH AND FLUSH SURFACE AT ALL FIELD ENTRANCES AND MATERIAL TRANSITIONS. NO DIPS, LIPS OR GAPS ARE ACCEPTED.
- SUBGRADE MUST BE PREPARED AND COMPACTED IN ACCORDANCE WITH ALL RECOMMENDATIONS AND REQUIREMENTS PER GEOTECHNICAL REPORT.
- FIELD CONTRACTOR MUST ACCEPT SUBGRADE CONDITIONS PRIOR TO FIELD CONSTRUCTION.
- ALL ACCESSIBLE PATHWAYS MUST BE INSTALLED IN ACCORDANCE WITH ADA REQUIREMENTS.

EARTHWORK QUANTITIES:

CUT TO SUBGRADE =	2,180 CY
FILL =	485 CY
EXPORT TO BALANCE =	<u>1,695 CY</u>

GRADING LEGEND:

- FG = FINISHED GRADE
- EX = EXISTING GRADE
- TC = TOP OF CURB
- BC = BOTTOM OF CURB
- = GRADE BREAK
- ← = SLOPE ARROW
- = LIMITS OF CONSTRUCTION

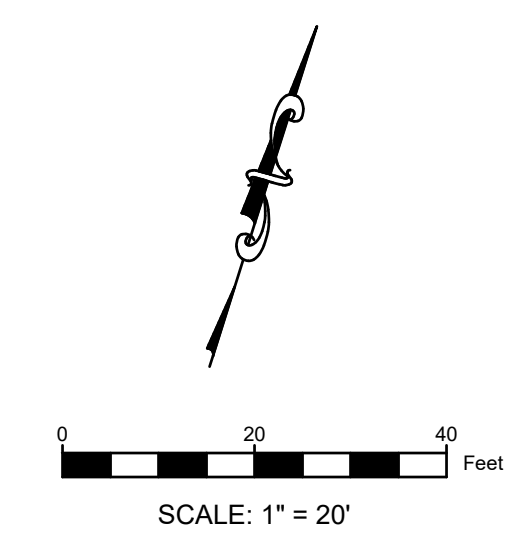

PRELIMINARY NOT FOR CONSTRUCTION

REV.	

COLLEGE OF THE SISKIYOU
SOCCER FIELD
 800 College Avenue
 Weed, CA





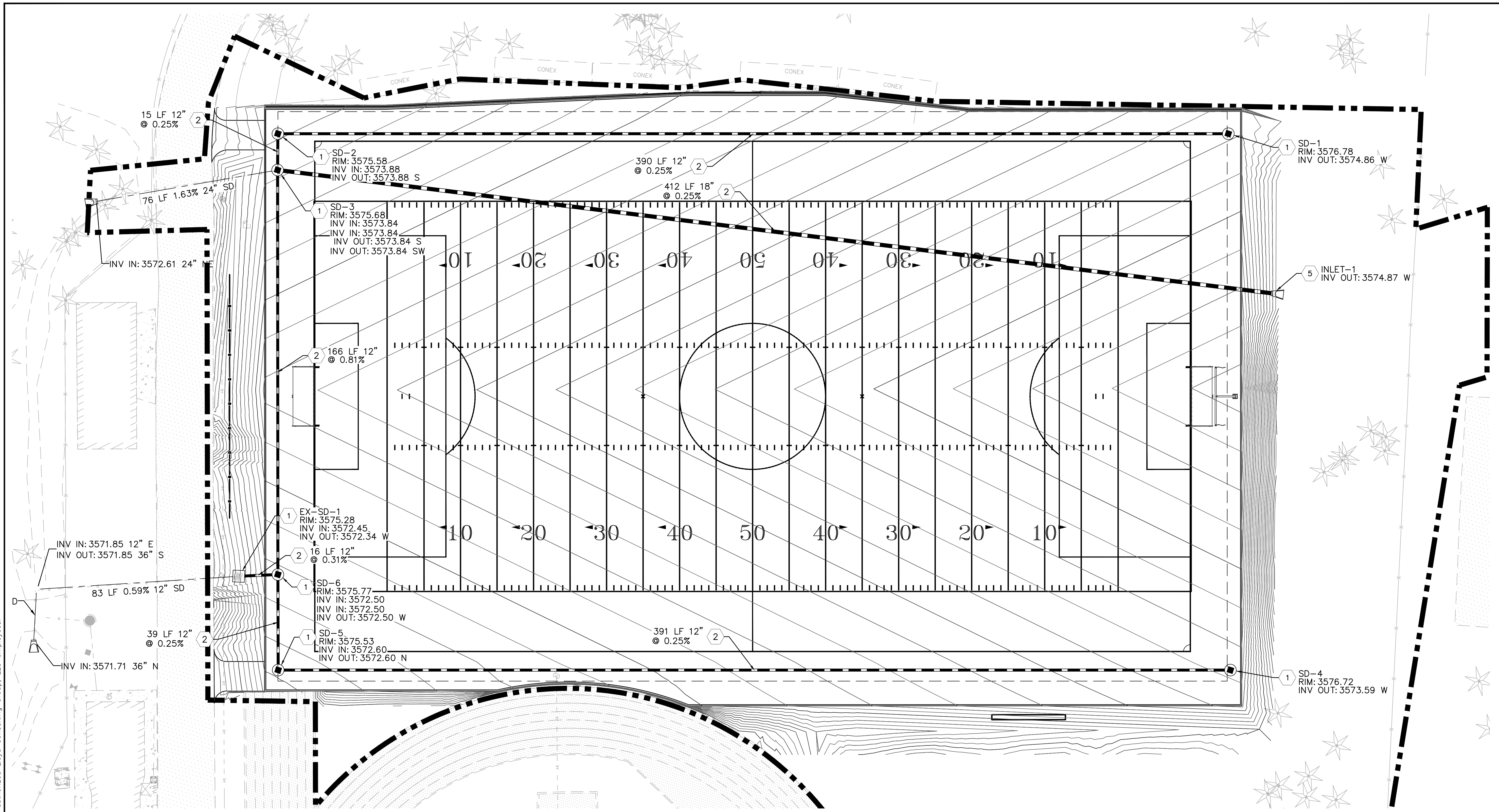

SCALE:	1"=20'
DESIGNED:	BTL
DATE:	8/30/2018
DRAWN:	TML
PROJ.	17-173
APPROVED:	

GRADING PLAN

DWG. NO.
PF-04



DRAINAGE LEGEND:

-  PERFORATED CHDPE PERIMETER PIPE
-  NON-PERFORATED CHDPE STORM DRAIN PIPE
-  24" PRECAST DRAIN BASIN
-  GRATED CATCH BASIN INLET
-  FLARED END SECTION
-  SURFACE FLOW DIRECTION

DRAINAGE PLAN NOTES:

- 1 INSTALL 24" ROUND DRAIN BASIN BELOW SYNTHETIC TURF PLAYING FIELD PER SPECIFICATIONS.
- 2 INSTALL PERFORATED SMOOTH INTERIOR CHDPE PERIMETER DRAIN PIPE PER SPECIFICATIONS (SIZE PER PLAN).
- 3 INSTALL NON-PERFORATED SMOOTH INTERIOR CHDPE PERIMETER DRAIN PIPE PER SPECIFICATIONS (SIZE PER PLAN).
- 4 INSTALL SQUARE DRAIN BASIN PER PER SPECIFICATIONS (SIZE PER DETAIL).
- 5 INSTALL HDPE FLARED END SECTION INLET.

PRELIMINARY NOT
 FOR CONSTRUCTION

REV.	

COLLEGE OF THE SISKIYOU
 SOCCER FIELD
 800 College Avenue
 Weed, CA

SCALE:	1"=20'
DESIGNED:	BTL
DATE:	8/30/2018
DRAWN:	TML
PROJ.	17-173
APPROVED:	

DRAINAGE PLAN

DWG. NO.
PF-05

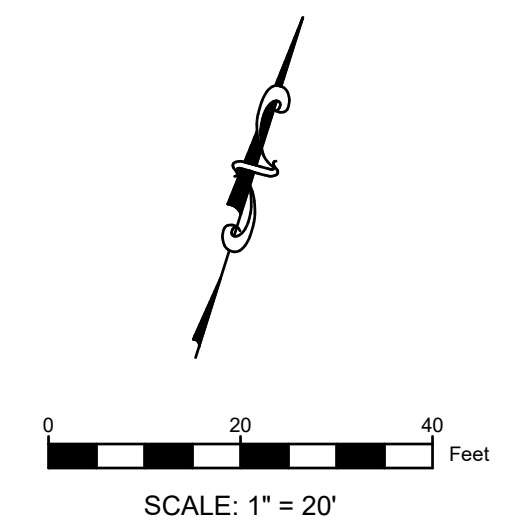

This plan document set is the sole property of Lloyd Consulting Group, LLC. No alterations to these plans, other than adding "as-built" information, are allowed by anyone other than authorized Lloyd Consulting Group, LLC employees.

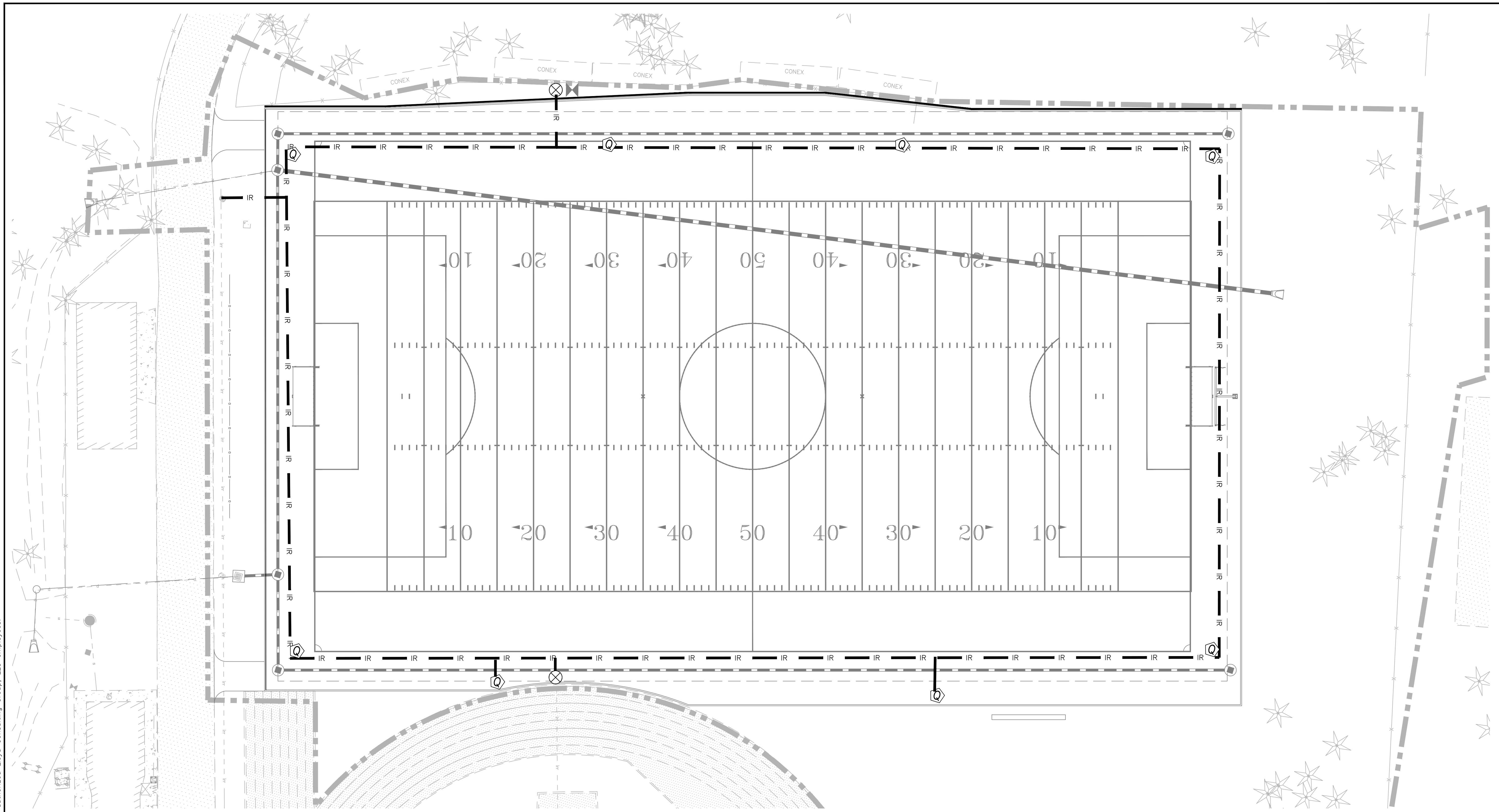

COOLING SYSTEM EQUIPMENT LEGEND:

- ➔ CONNECT TO EXISTING IRRIGATION MAINLINE
- IRRIGATION MAINLINE (2" EXCEPT WHERE NOTED OTHERWISE)
SOLVENT WELD CLASS 200 PVC W/ SCH 80 FITTINGS
- ⊗ ISOLATION GATE VALVE (SIZE TO MATCH MAINLINE)
NIBCO T113-K
- Ⓢ QUICK COUPLER VALVE (1" SIZE)
RAINBIRD 44-RC IN SYNTHETIC TURF COMBOX

COOLING SYSTEM GENERAL NOTES:

1. CONNECT TO EXISTING MAINLINE THE APPROXIMATE LOCATION SHOWN. FLOW AND PRESSURE MUST BE VERIFIED BY CONTRACTOR PRIOR TO CONSTRUCTION. IF PRESSURE IS LESS THAN 50 PSI AT 40GPM NOTIFY ENGINEER IMMEDIATELY.
2. REFER TO SPECIFICATIONS FOR ALL PRESSURE TESTING AND FLUSHING REQUIREMENTS.
3. ALL IRRIGATION VALVE AND PIPE SYMBOL LOCATIONS ARE DIAGRAMMATIC. DO NOT INSTALL IRRIGATION EQUIPMENT IN DIRECT CONFLICT WITH UTILITY, LANDSCAPE, OR HARDSCAPE ELEMENTS. COORDINATE LOCATION OF ALL NEW AND EXISTING UTILITIES PRIOR TO IRRIGATION INSTALLATION. CONTACT ENGINEER IMMEDIATELY IF CONFLICTS ARE LOCATED.
4. EXISTING UTILITIES SHOWN ARE FOR REFERENCE ONLY. ADDITIONAL UTILITIES MAY BE PRESENT. CONTRACTOR MUST UTILIZE UTILITY LOCATION SERVICE PRIOR TO CONSTRUCTION AND TRENCH WITH CAUTION. CONTRACTOR IS RESPONSIBLE TO REPAIR OR REPLACE ANY UTILITIES DAMAGED DURING CONSTRUCTION.
5. CUT AND CAP ANY ACTIVE IRRIGATION LINES ENTERING THE TRACK AREA. CONTRACTOR MUST AS-BUILT ALL LIVE IRRIGATION LINES FOUND DURING CONSTRUCTION.
6. CONTRACTOR IS REQUIRED TO VERIFY THAT FLOW AND AUTOMATIC CONTROL TO ALL LANDSCAPE IRRIGATION SURROUNDING THE TRACK REMAINS FUNCTIONAL DURING AND AFTER CONSTRUCTION.

PRELIMINARY NOT FOR CONSTRUCTION

REV.	

COLLEGE OF THE SISKIYOU SOCCER FIELD
 800 College Avenue
 Weed, CA

SCALE:	1"=20'
DESIGNED:	BTL
DATE:	8/30/2018
DRAWN:	TML
PROJ.	17-173
APPROVED:	

IRRIGATION PLAN

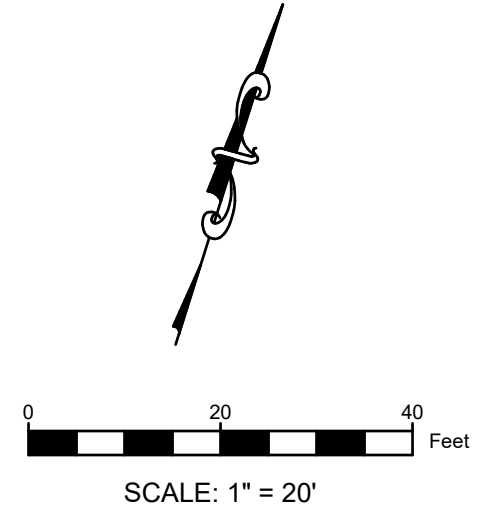

DWG. NO.
PF-06

This plan document set is the sole property of Lloyd Consulting Group, LLC. No alterations to these plans, other than adding "as-built" information, are allowed by anyone other than authorized Lloyd Consulting Group, LLC employees.

This plan document set is the sole property of Lloyd Consulting Group, LLC. No alterations to these plans, other than adding "as-built" information, are allowed by anyone other than authorized Lloyd Consulting Group, LLC employees.

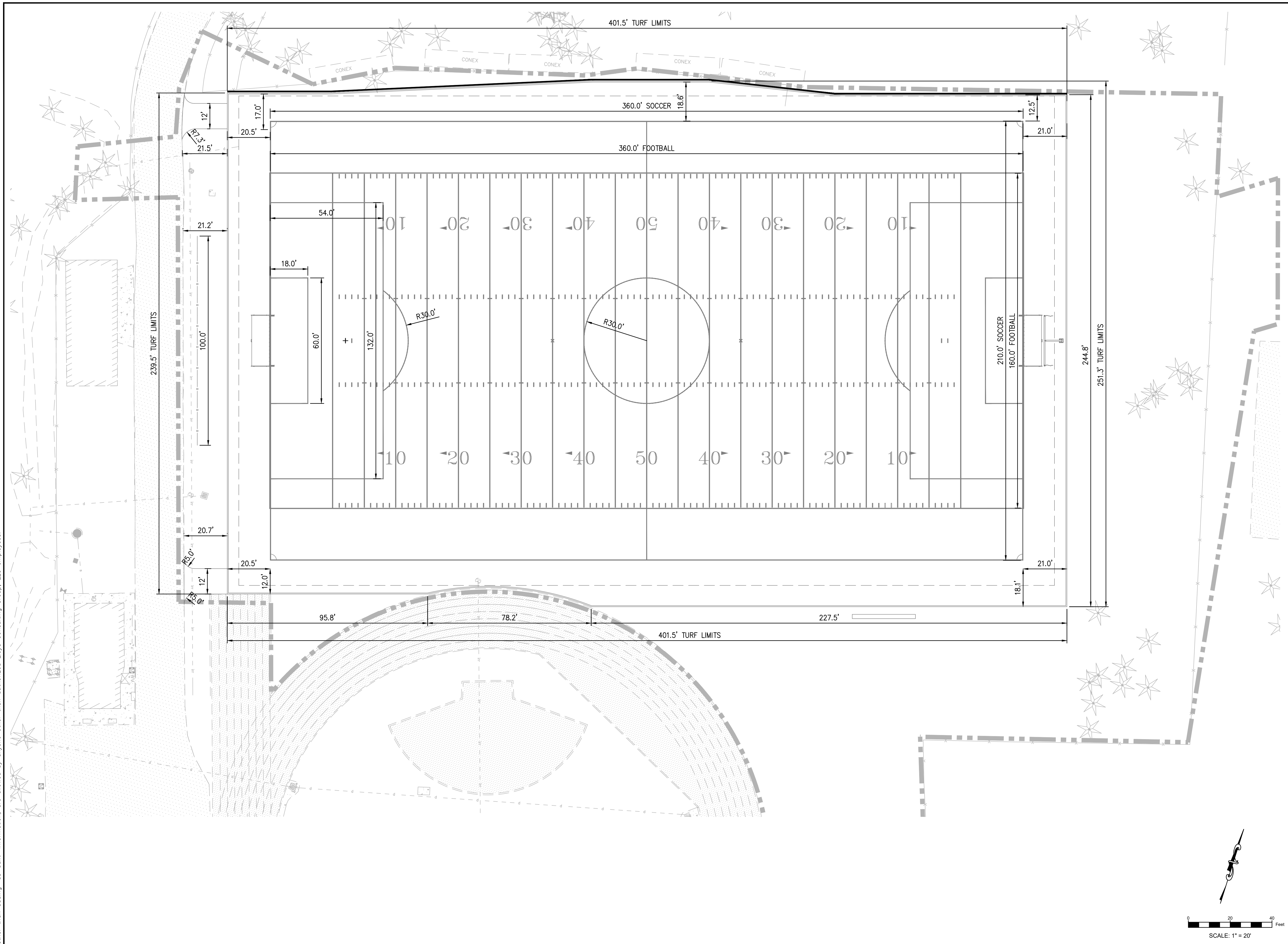

PRELIMINARY NOT FOR CONSTRUCTION

REV.	DESCRIPTION

COLLEGE OF THE SISKIYOU
SOCCKER FIELD
 800 College Avenue
 Weed, CA

SCALE:	1"=20'
DESIGNED:	BTL
DATE:	8/30/2018
DRAWN:	TML
PROJ.	17-173
APPROVED:	

DIMENSION PLAN

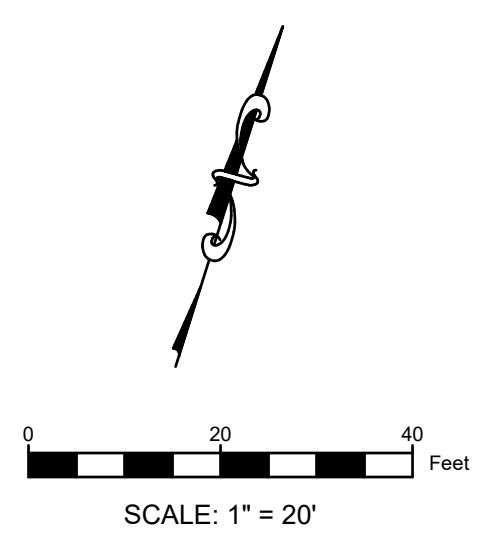

DWG. NO.
PF-08

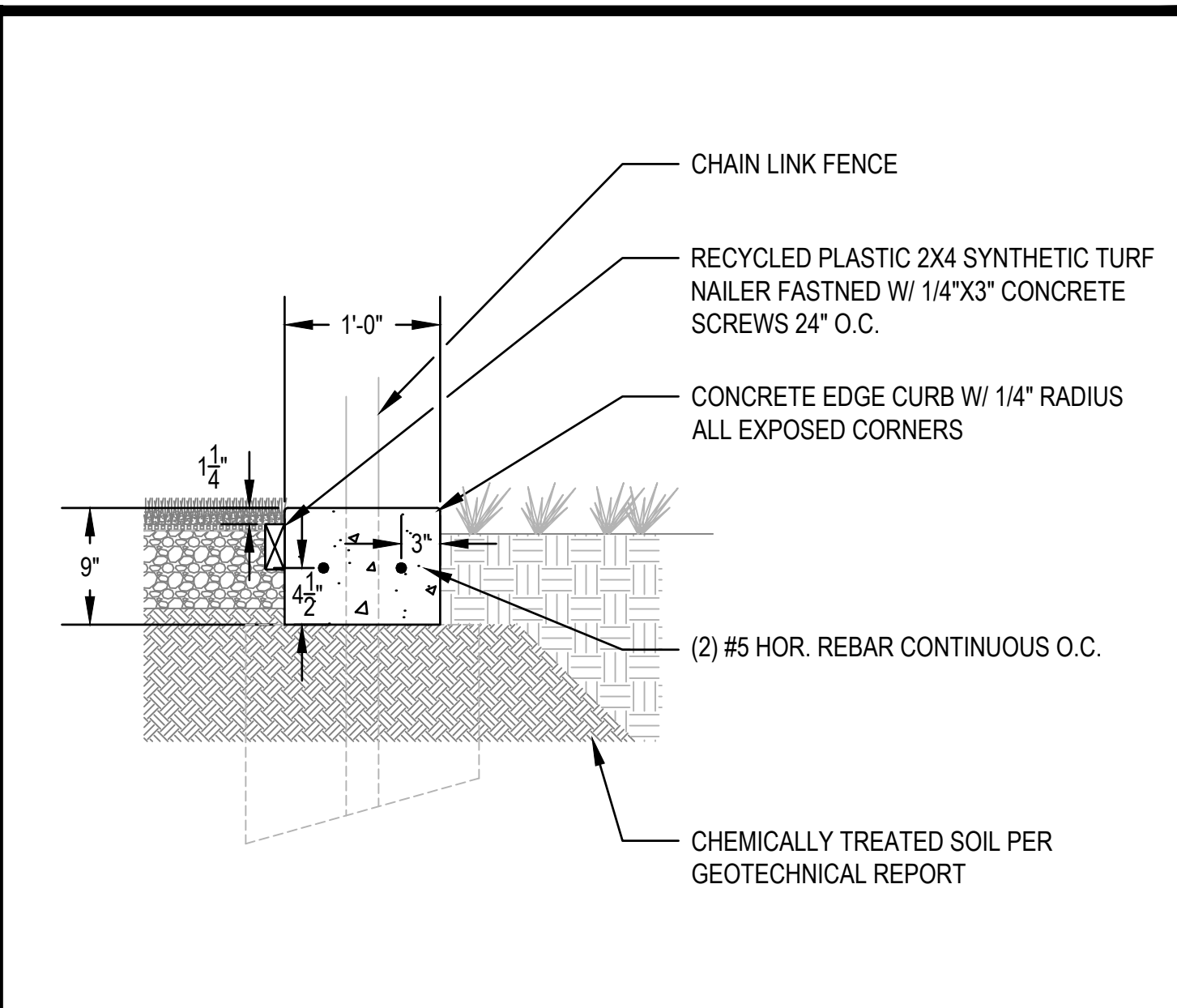
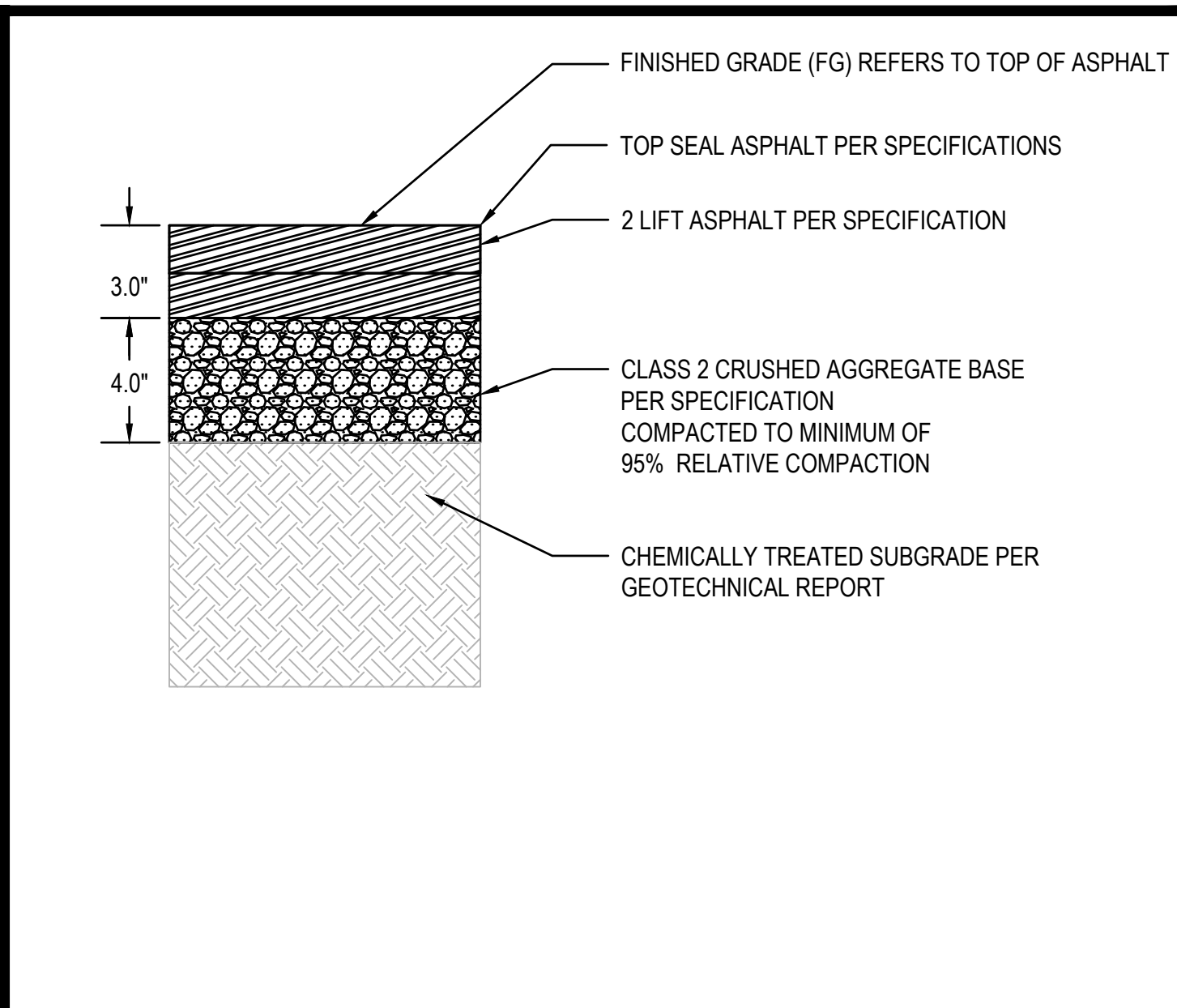
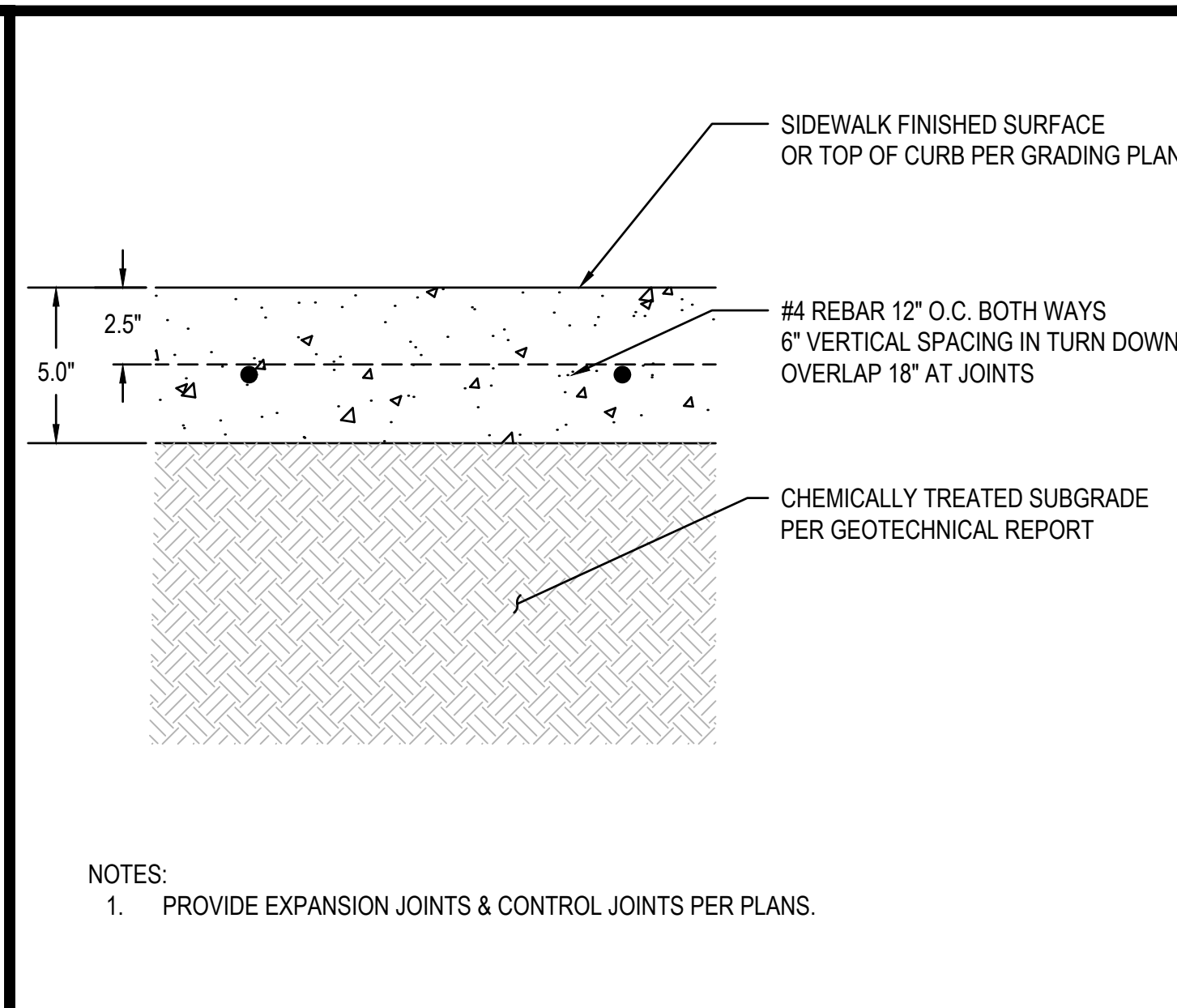
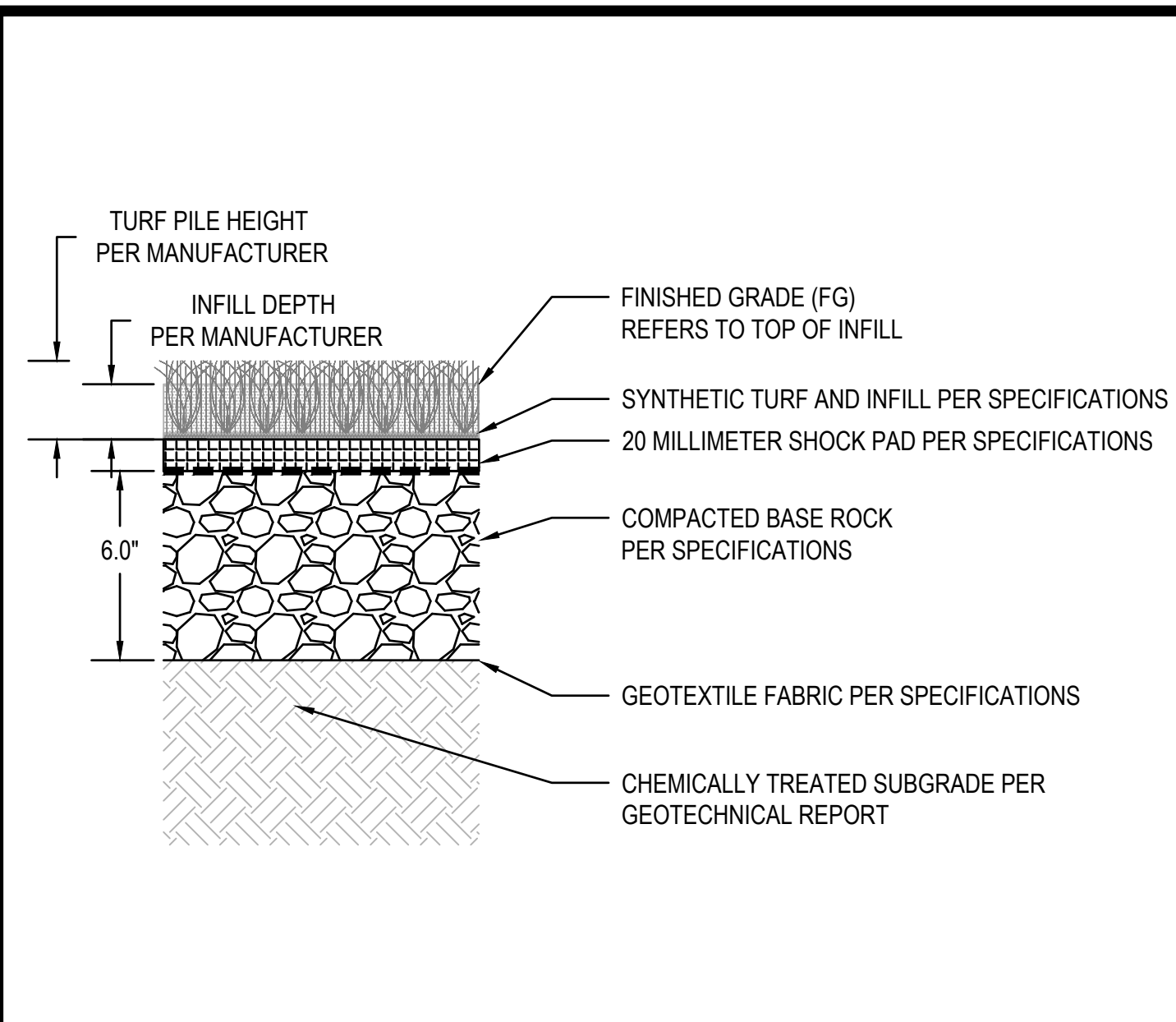

01 SYNTHETIC TURF SECTION
 SCALE: NTS

02 CONCRETE PAVING SECTION
 SCALE: NTS

03 ASPHALT PAVING SECTION
 SCALE: NTS

04 CONCRETE EDGE CURB
 SCALE: NTS

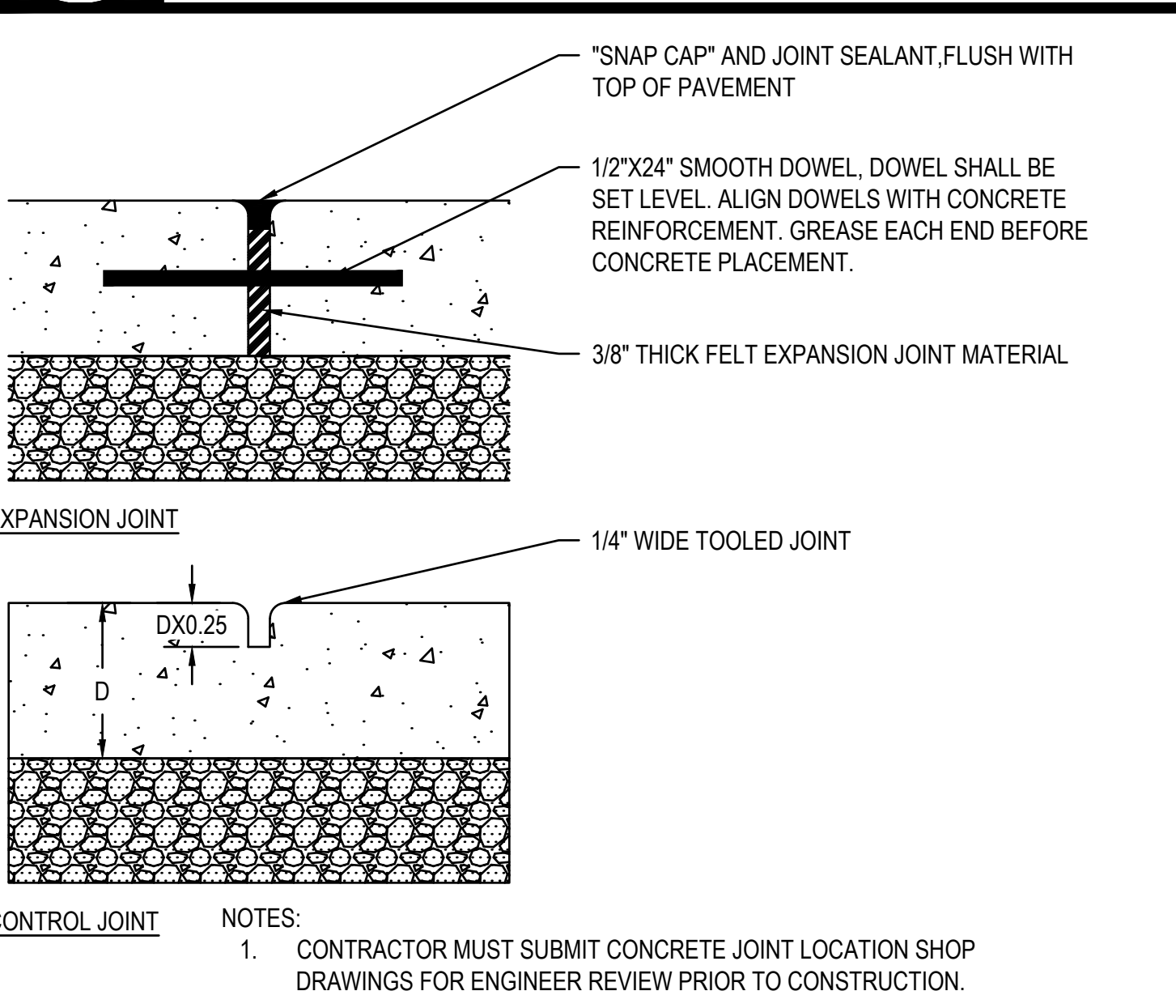
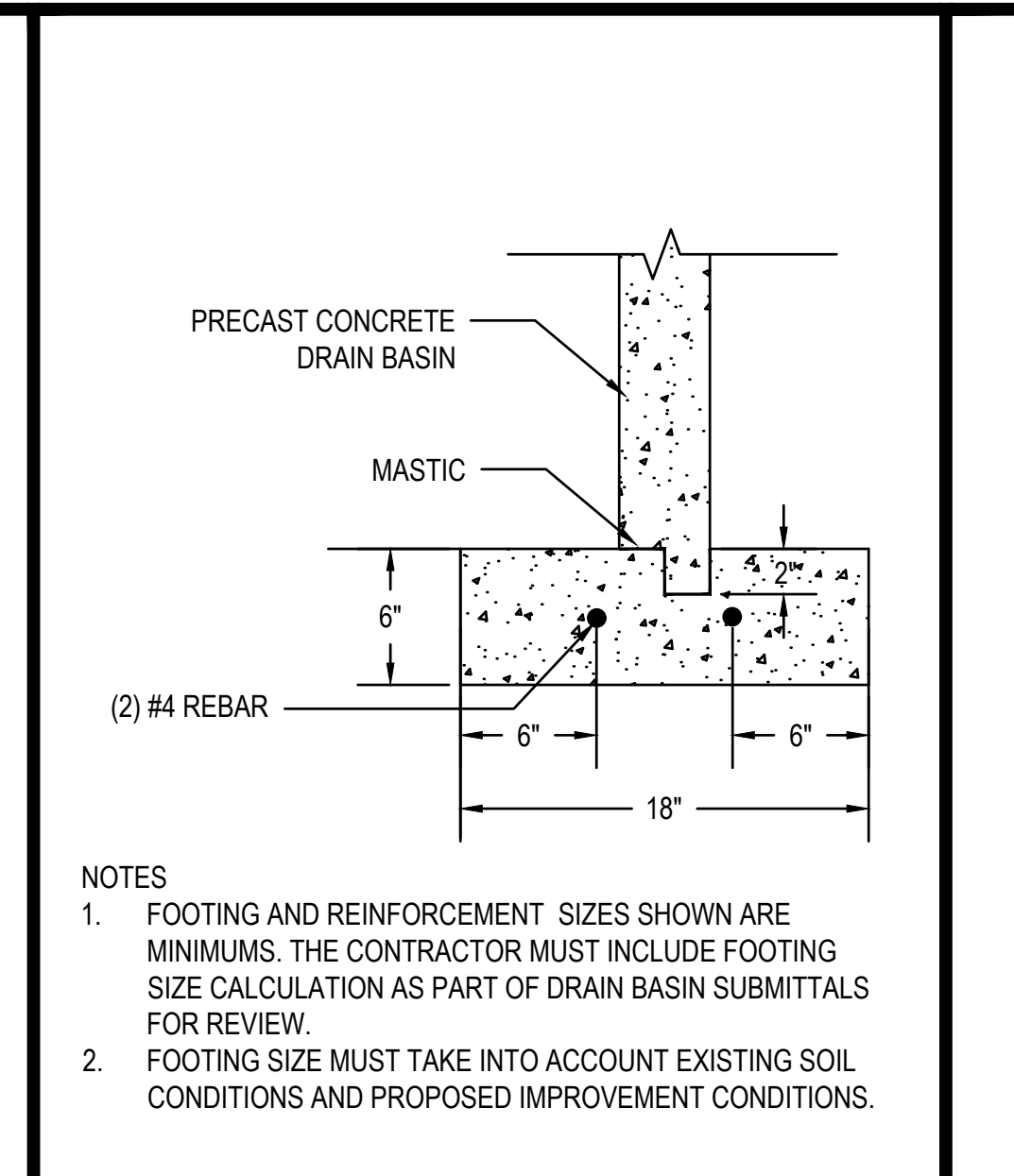
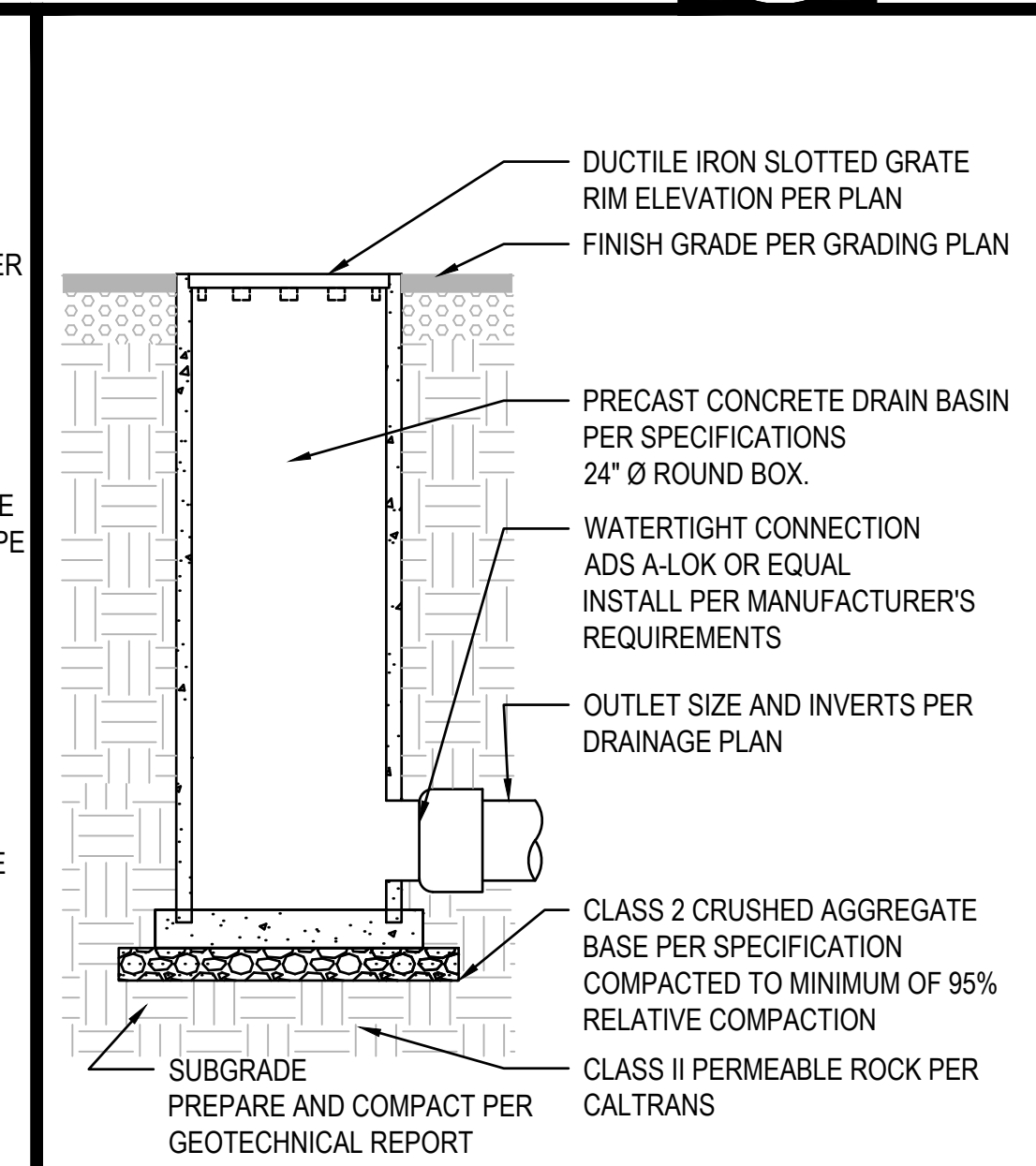
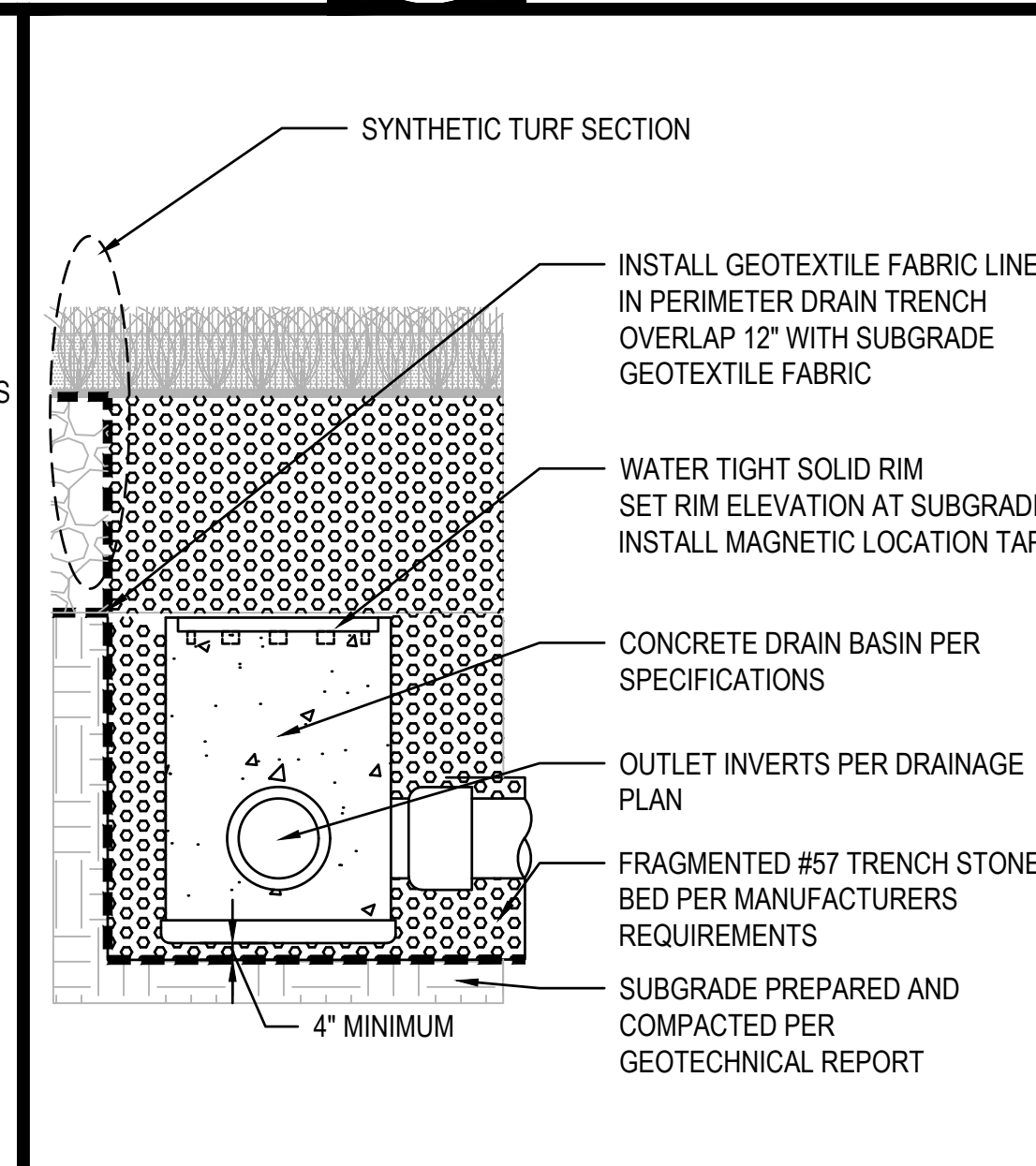
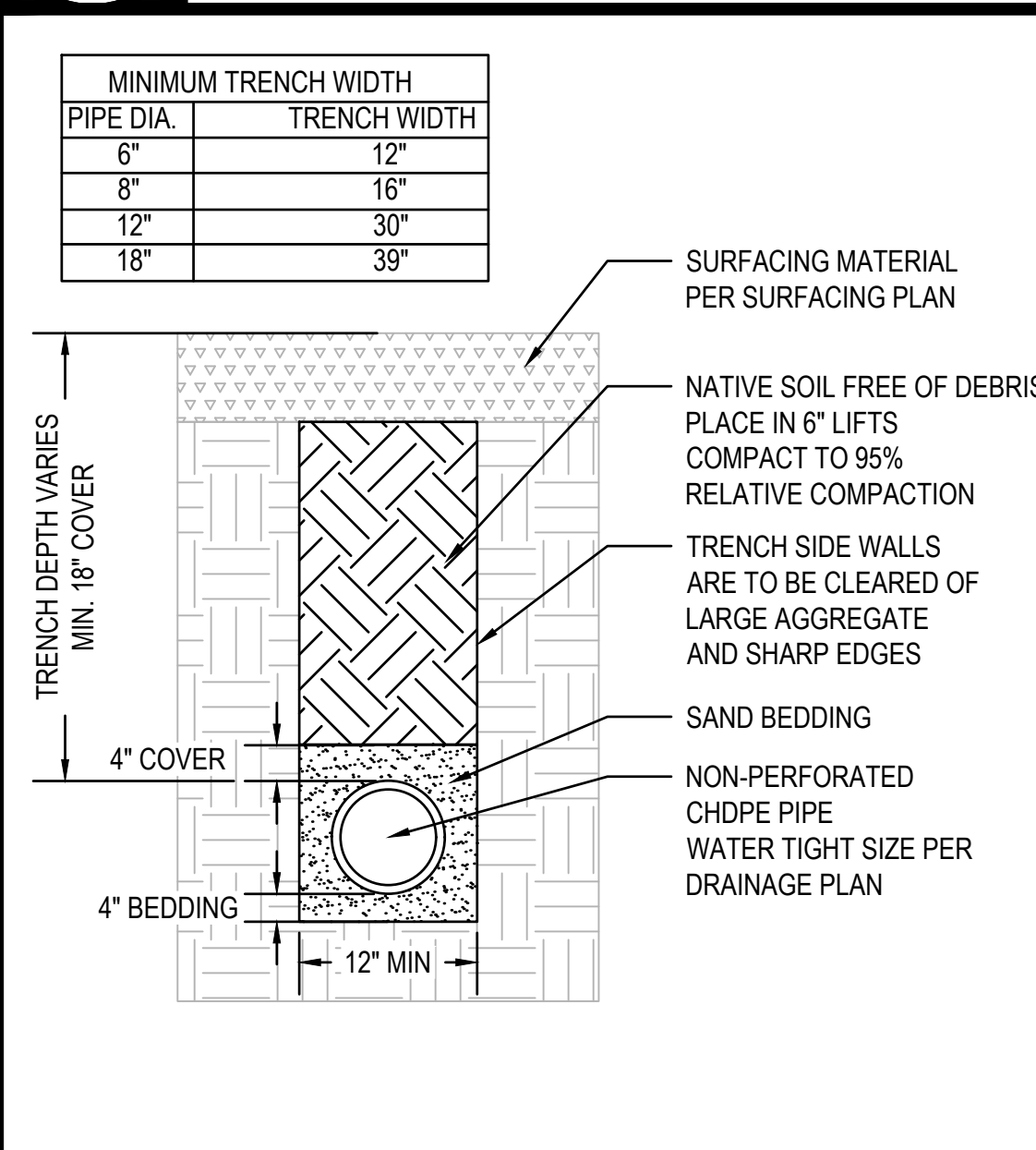

05 NON-PERFORATED STORM DRAIN TRENCH
 SCALE: NTS

06 DRAIN BASIN IN SYNTHETIC TURF
 SCALE: NTS

07 DRAIN BASIN
 SCALE: NTS

08 DRAIN BASIN FOOTING
 SCALE: NTS

11 TYPICAL SIDEWALK AND CURB JOINTS
 SCALE: NTS

MINIMUM TRENCH WIDTH	PIPE DIA.	TRENCH WIDTH
6"	6"	12"
8"	8"	16"
12"	12"	30"
18"	18"	39"

INSTALL GEOTEXTILE FABRIC LINER IN PERIMETER DRAIN TRENCH OVERLAP 12" WITH SUBGRADE GEOTEXTILE FABRIC

WATER TIGHT SOLID RIM SET RIM ELEVATION AT SUBGRADE INSTALL MAGNETIC LOCATION TAPE

CONCRETE DRAIN BASIN PER SPECIFICATIONS

OUTLET INVERTS PER DRAINAGE PLAN

FRAGMENTED #57 TRENCH STONE BED PER MANUFACTURERS REQUIREMENTS

SUBGRADE PREPARED AND COMPACTED PER GEOTECHNICAL REPORT

4" MINIMUM

DUCTILE IRON SLOTTED GRATE RIM ELEVATION PER PLAN

FINISH GRADE PER GRADING PLAN

PRECAST CONCRETE DRAIN BASIN PER SPECIFICATIONS 24" Ø ROUND BOX.

WATERTIGHT CONNECTION ADS A-LOK OR EQUAL INSTALL PER MANUFACTURER'S REQUIREMENTS

OUTLET SIZE AND INVERTS PER DRAINAGE PLAN

CLASS 2 CRUSHED AGGREGATE BASE PER SPECIFICATION COMPACTED TO MINIMUM OF 95% RELATIVE COMPACTION

CLASS II PERMEABLE ROCK PER CALTRANS

SUBGRADE PREPARE AND COMPACT PER GEOTECHNICAL REPORT

PRECAST CONCRETE DRAIN BASIN

MASTIC

(2) #4 REBAR

6"

6"

18"

NOTES:
 1. FOOTING AND REINFORCEMENT SIZES SHOWN ARE MINIMUMS. THE CONTRACTOR MUST INCLUDE FOOTING SIZE CALCULATION AS PART OF DRAIN BASIN SUBMITTALS FOR REVIEW.
 2. FOOTING SIZE MUST TAKE INTO ACCOUNT EXISTING SOIL CONDITIONS AND PROPOSED IMPROVEMENT CONDITIONS.

"SNAP CAP" AND JOINT SEALANT, FLUSH WITH TOP OF PAVEMENT

1/2"X24" SMOOTH DOWEL, DOWEL SHALL BE SET LEVEL. ALIGN DOWELS WITH CONCRETE REINFORCEMENT. GREASE EACH END BEFORE CONCRETE PLACEMENT.

3/8" THICK FELT EXPANSION JOINT MATERIAL

EXPANSION JOINT

1/4" WIDE TOOLED JOINT

CONTROL JOINT

NOTES:
 1. CONTRACTOR MUST SUBMIT CONCRETE JOINT LOCATION SHOP DRAWINGS FOR ENGINEER REVIEW PRIOR TO CONSTRUCTION.

PRELIMINARY NOT FOR CONSTRUCTION

REV.

COLLEGE OF THE SISKIYOU
 SOCCER FIELD
 800 College Avenue
 Weed, CA

SCALE:	AS NOTED
DESIGNED:	BTL
DATE:	8/30/2018
DRAWN:	TML
PROJ.:	17-173
APPROVED:	

DETAILS
 DWG. NO.
PF-10.1

This plan document set is the sole property of Lloyd Consulting Group, LLC. No alterations to these plans, other than adding "as-built" information, are allowed by anyone other than authorized Lloyd Consulting Group, LLC employees.

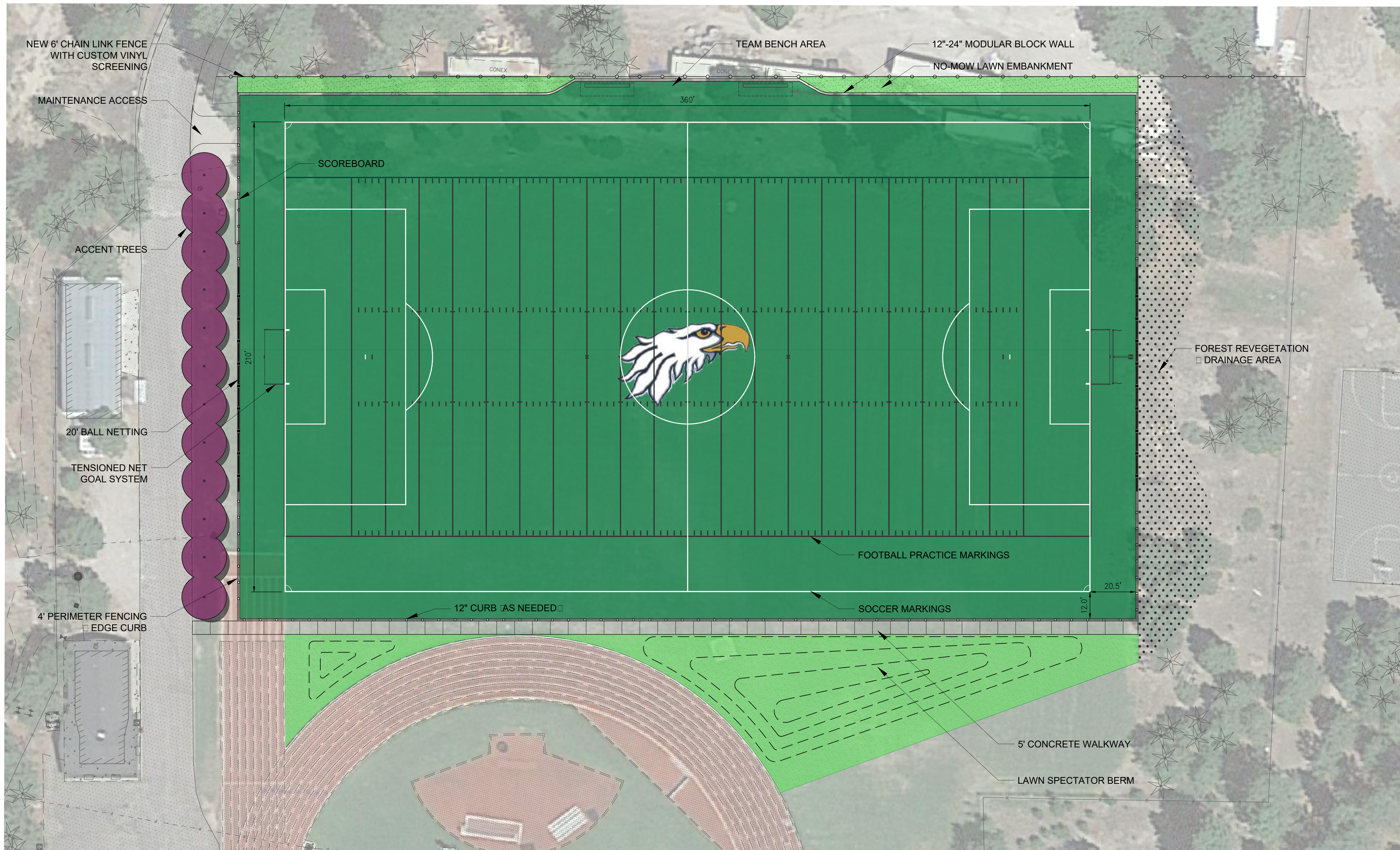

FIELD COLOR LEGEND

- SYNTHETIC TURF COLOR (GREEN)
- SOCCER LINES (WHITE)
- FOOTBALL PRACTICE LINES (GRAY)

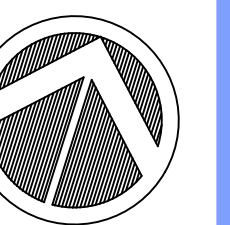

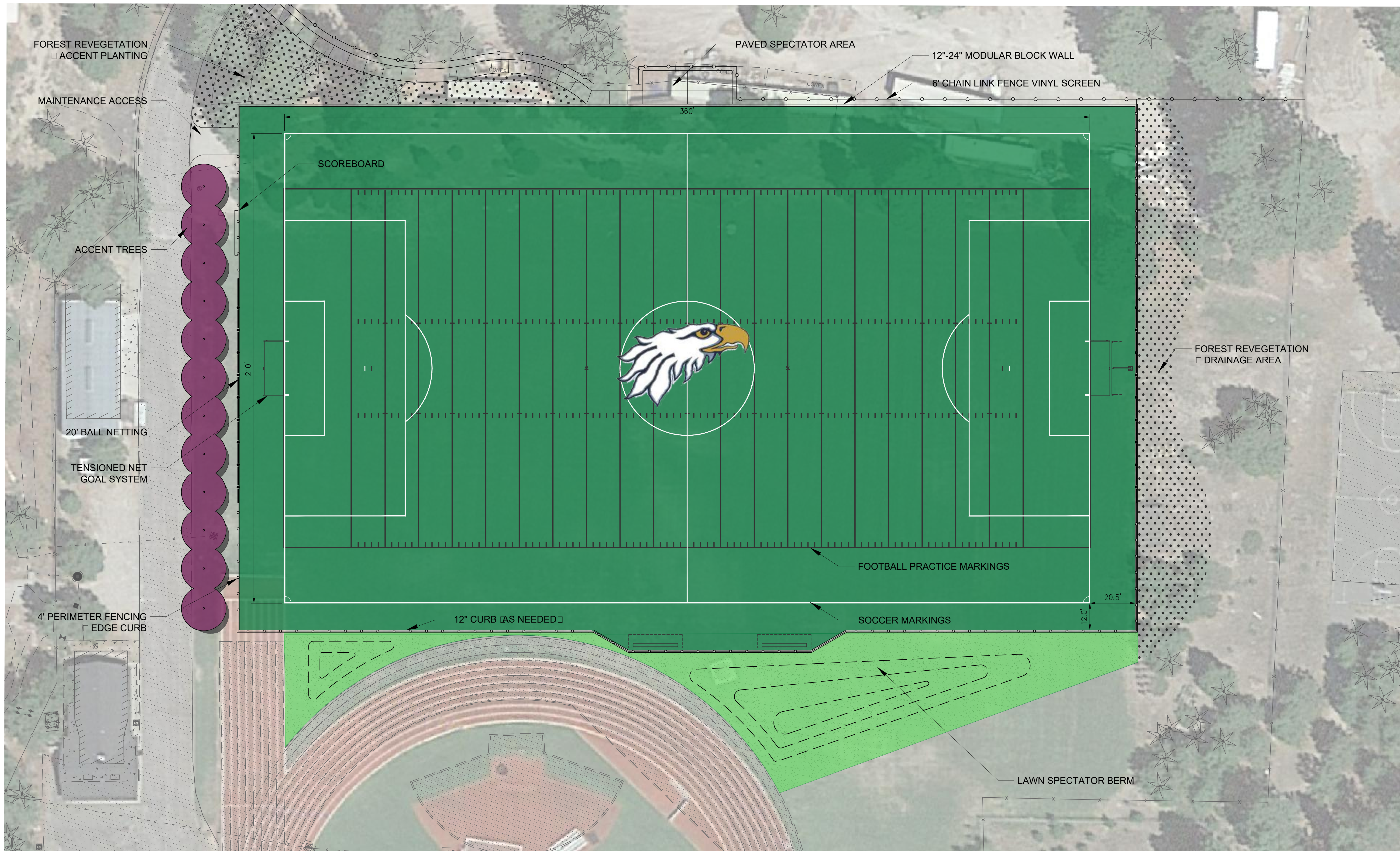

FIELD COLOR LEGEND

- SYNTHETIC TURF COLOR (GREEN)
- SOCCER LINES (WHITE)
- FOOTBALL PRACTICE LINES (GRAY)

