

Plot Date: May 04, 2007 - 8:50 am
 File Name: N:\Projects\3000\Education\06-232700 COS Tactical Training Support Center Drawings\COS TTSC_sabawg

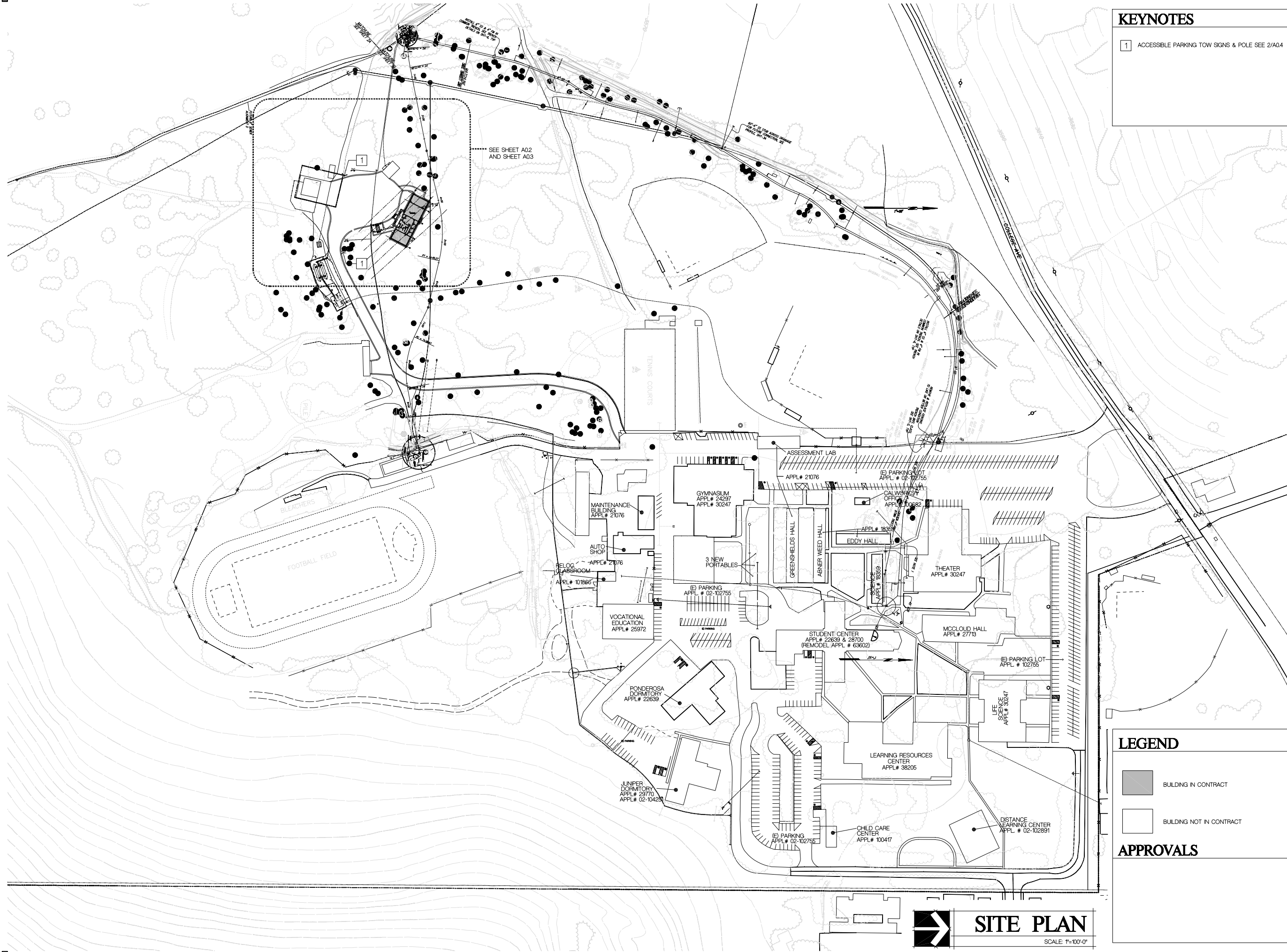

KEYNOTES

1 ACCESSIBLE PARKING TOW SIGNS & POLE SEE 2/A04

Copyright © 2001

All ideas, designs, arrangements and plans indicated or represented by this drawing are owned by, and the property of, NICHOLS MELBURG and ROSSETTO and were created, evolved and developed for use in and in conjunction with the specified project. None of such ideas, designs, arrangements or plans shall be used by or disclosed to any person, firm or corporation for any purpose whatsoever without the written permission of NICHOLS MELBURG and ROSSETTO.

NICHOLS MELBURG ROSSETTO ARCHITECTS + ENGINEERS
 300 KNOLLCREST DRIVE
 REDDING, CA. 96002
 (530) 222-3300 (530) 222-3538 FAX
 http://www.nmrdesign.com

CONSULTANTS

LICENSE STAMPS

PROJECT NAME
COLLEGE OF THE SISKIYOU

TACTICAL TRAINING SUPPORT CTR

WEED, CALIFORNIA

SHEET TITLE
OVERALL SITE PLAN

DRAWING STATUS
CONSTRUCTION DOCUMENTS
 DSA SUBMITTAL

REVISIONS

Sym.	Description	By	Date

Drawn By	CLH, AK
Checked By	WK
Date Drawn	03/07
Scale	AS NOTED
Job No.	06-2327

SHEET No.
A0.1

LEGEND

■ BUILDING IN CONTRACT

□ BUILDING NOT IN CONTRACT

APPROVALS

SITE PLAN
 SCALE 1"=100'-0"